

Thank you for your choice of the Bachmann Branchline Fowler 4F 0-6-0 tender locomotive.

Running in

The mechanism of this model requires running in (without a load) for approximately 1 hour in each direction at moderate speed.

Curves

Bachmann Branchline locomotives perform best on curves of second radius or greater (approx. 18 inches / 450 mm).

Bodyshell removal

Remove the screws as indicated on the diagrams (right). The Deeley and Fowler tender types have different screw positions as indicated.

DCC Decoder fitting

This model has an 21-pin socket in the tender for a decoder. Remove the DC blanking plug and fit the decoder to the pins with the black fitting uppermost. We recommend that the running in as above be carried out using a DC power supply before moving on to fit a DCC decoder

Lubrication

When required, sparingly lubricate the motor bearings using plastic compatible light oil and the gear train with model grease.

Replacement parts

When ordering parts please quote the catalogue number together with the livery of the model (if appropriate) and number of the part required.

Parts are subject to availability.

Packets of couplers (item 36-030) and buffers (item 36-032) suitable for this model are available from retailers.

The model should be handled carefully as it has many finely detailed parts. It is not suitable for persons 14 years.

Bachmann Europe Plc

Moat Way, Barwell, Leicestershire, LE9 8EY
01455 841756

www.bachmann.co.uk

4F rev 1 04/13

E3188-IS001

Bodyshell removal

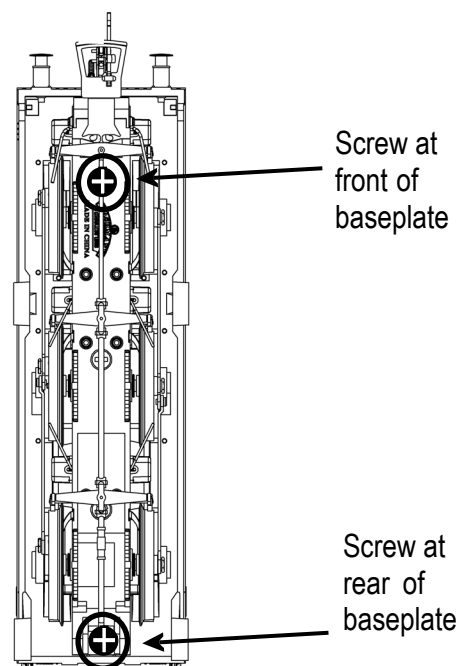

Deeley tender

Fowler tender

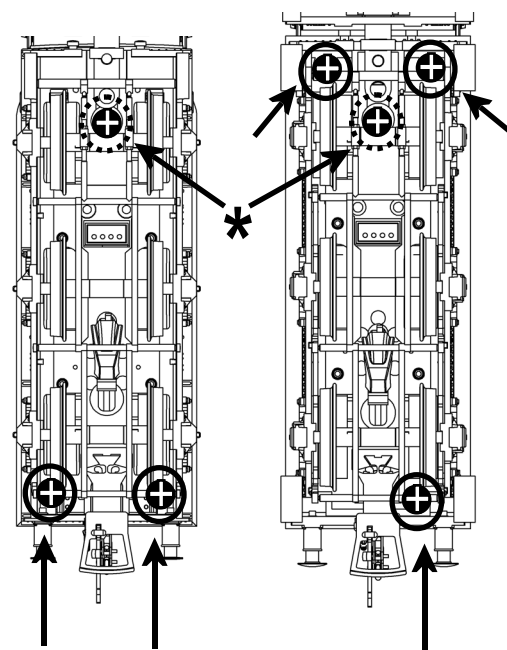

Secured by screws at rear corners, shell 'hinges' from front of tender

Secured by two screws at front corners and one at rear

* Adjustable length tender drawbar is secured by the screw indicated

Tender tank vents according to model
(if tender has water scoop)

Speaker cradle to
accept speaker
for aftermarket
sound decoder

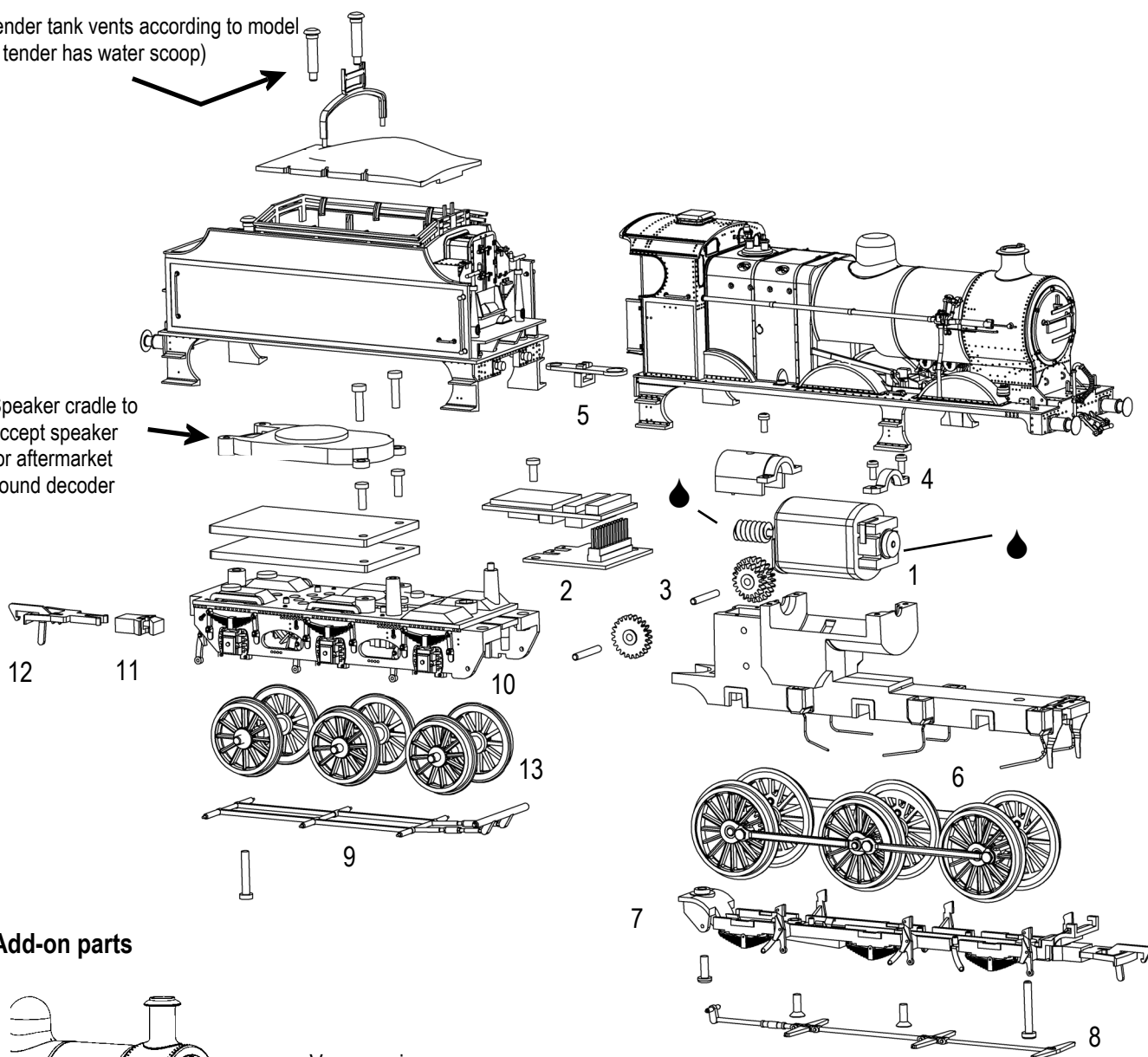

Add-on parts

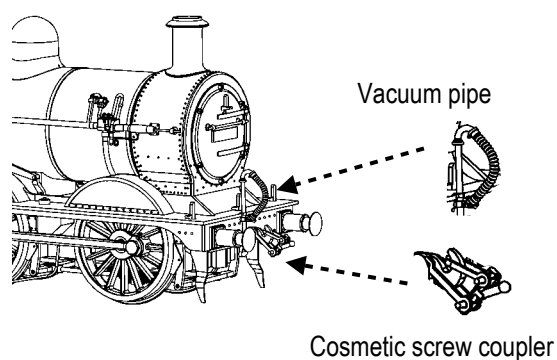

DCC Decoder fitting

Remove the DC blanking plug and fit the decoder to the pins with the black fitting uppermost.

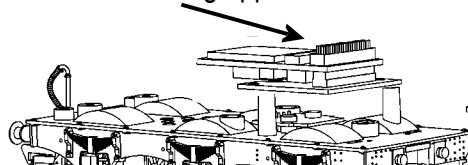

Parts

- | | |
|----|------------------------------|
| 1 | 880-106 motor |
| 2 | 880-004 circuit board |
| 3 | 880-112 gears |
| 4 | 880-113 motor clips |
| 5 | 880-130 drawbar |
| 6 | 880-117 driving wheels |
| 7 | 880-118 baseplate |
| 8 | 880-122 loco brake rigging |
| 9 | 880-123 tender brake rigging |
| 10 | 880-125 tender underframe |
| 11 | NEM pocket |
| 12 | coupling |
| 13 | 880-126 tender wheels |