

## Replacement Parts

- 1 700-201 motor
- 2 700-202 baseplate
- 3 700-203 driving wheels
- 4 700-205 valve gear
- 5 700-206 bogie
- 6 700-121 loco brake rodding
- 7 700-119 tender brake rodding
- 8 700-204 tender underframe
- 9 700-207 PCB
- 10 700-208 tender wheels

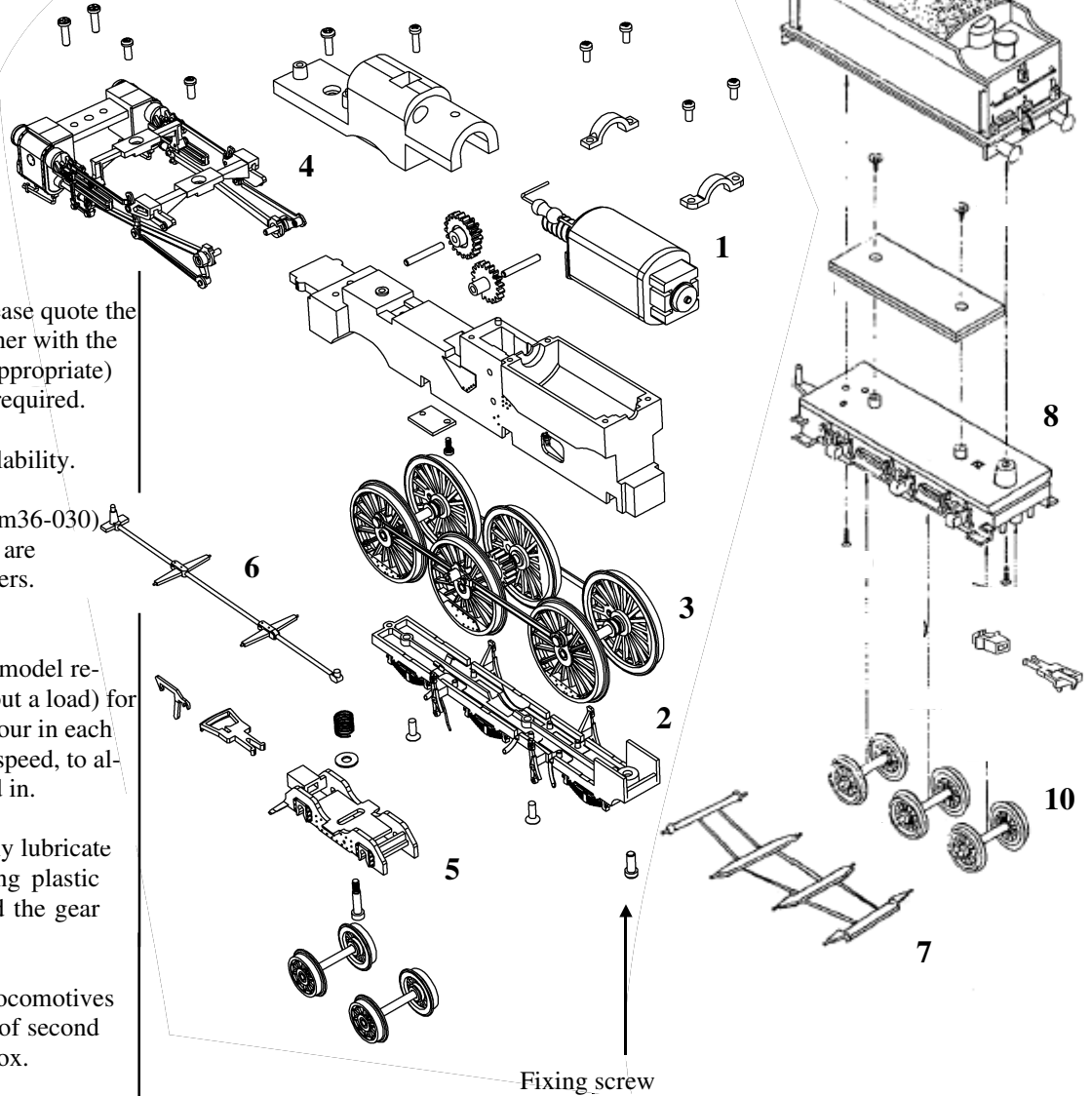
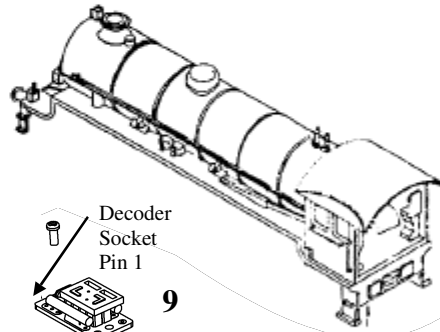

When ordering parts please quote the catalogue number together with the livery of the model (if appropriate) and number of the part required.

Parts are subject to availability.

Packets of couplers (item 36-030) suitable for the model are available from the retailers.

### General

The Mechanism of this model requires running in (without a load) for approximately half an hour in each direction at a moderate speed, to allow the gear train to bed in.

When required, sparingly lubricate the motor bearings using plastic compatible light oil and the gear train with model grease.

Bachmann Branchline locomotives perform best on curves of second radius or greater (approx. 18 inches / 450 mm).

### Bachmann Europe Plc

Moat Way, Barwell, Leicestershire  
LE9 8EY  
01455 841756

[www.bachmann.co.uk](http://www.bachmann.co.uk)