

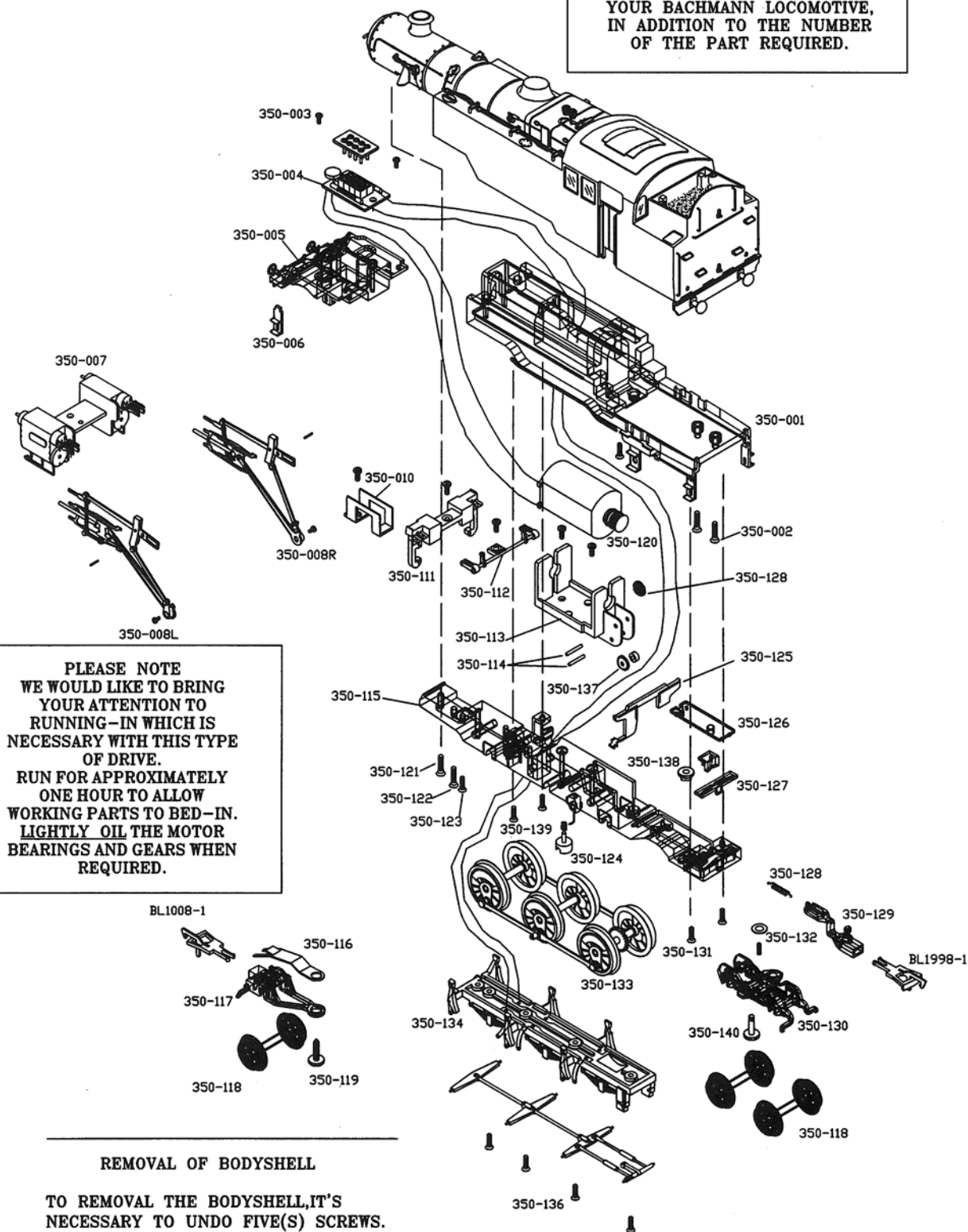

CLASS 4MT LOCOMOTIVE

IMPORTANT!

WHEN ORDERING ANY REPLACEMENT PARTS PLEASE ENSURE TO QUOTE THE APPROPRIATE CATALOGUE NUMBER/LIVERY OF YOUR BACHMANN LOCOMOTIVE, IN ADDITION TO THE NUMBER OF THE PART REQUIRED.



PLEASE NOTE WE WOULD LIKE TO BRING YOUR ATTENTION TO RUNNING-IN WHICH IS NECESSARY WITH THIS TYPE OF DRIVE. RUN FOR APPROXIMATELY ONE HOUR TO ALLOW WORKING PARTS TO BED-IN. LIGHTLY OIL THE MOTOR BEARINGS AND GEARS WHEN REQUIRED.

REMOVAL OF BODYSHELL

TO REMOVAL THE BODYSHELL, IT'S NECESSARY TO UNDO FIVE(S) SCREWS. THESE ARE IDENTIFIED BY THE DOTTED LINES IN THE DRAWING