

Thank you for your choice of the Bachmann Branchline BR Standard 4MT 4-6-0 locomotive.

Running In

The mechanism of this model requires running in (without a load) for approximately 1 hour in each direction at moderate speed.

Curves

Bachmann Branchline locomotives are not suitable for use on track tighter than second radius (18 inches). The short position of the tender drawbar is not suitable for tight curves.

Body removal

Remove the two screws indicated on the diagram.

DCC Decoder fitting to non DCC fitted loco

This model has an 8-pin NMRA/NEM socket for a decoder with an appropriate plug. The plug should be aligned so that Pin 1 (Orange wire) is aligned to the mark on the PCB. Note that the locomotive will run in backwards if the decoder is reversed.

We recommend that the running in as above be carried out using a DC power supply before moving on to fit a DCC decoder

Lubrication

When required, sparingly lubricate the motor bearings using plastic compatible light oil and the gear train with model grease.

Buffer beam pipes and front footsteps.

The locomotive vacuum pipes fit and front footsteps fit as shown. The front steps may not be suitable for tight curves - check before fitting permanently.

The model should be handled carefully as it has many finely detailed parts. It is not suitable for persons under 14 years.

Location of body securing screws

Front screw accessible through hole in the bogie

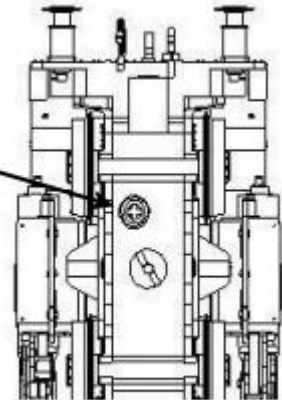

Rear screw under brake actuator

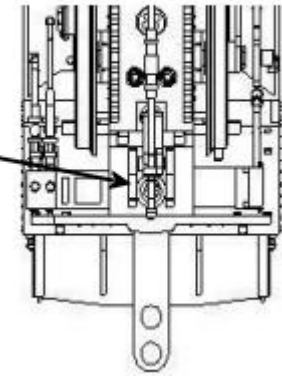

Location of vacuum pipes and steps

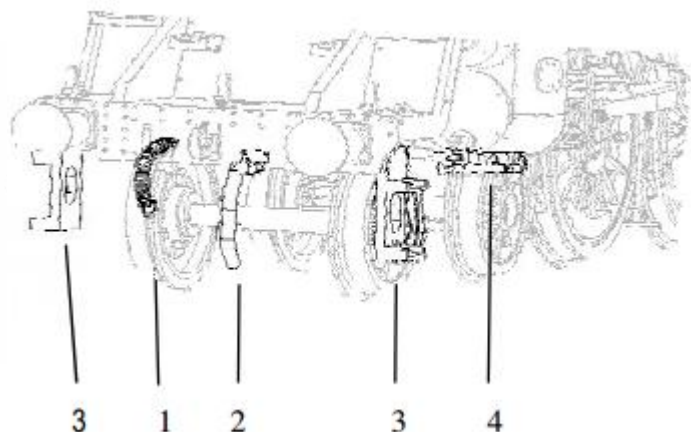

1. Vacuum pipe
2. Steam heat pipe
3. Front footplate steps
4. Cylinder draincocks
5. Cab door - see diagram overleaf

Parts

- 1 110-103 cylinders / valve gear
 - 2 110-106 motor
 - 3 110-114 drawbar
 - 4 110-117 driving wheels
 - 5 110-118 baseplate
 - 6 110-121 front pony truck
 - 7 110-122 loco brake rods
 - 8 110-123 accessory pack
 - 9 BL1999 coupling
 - 10 350-004 circuit board
- 110-124 tender underframe BR1B
 110-125 tender underframe BR2
 110-126 tender brake rods BR1B
 110-127 tender brake rigging BR2
 BL2006 NEM pocket for tender

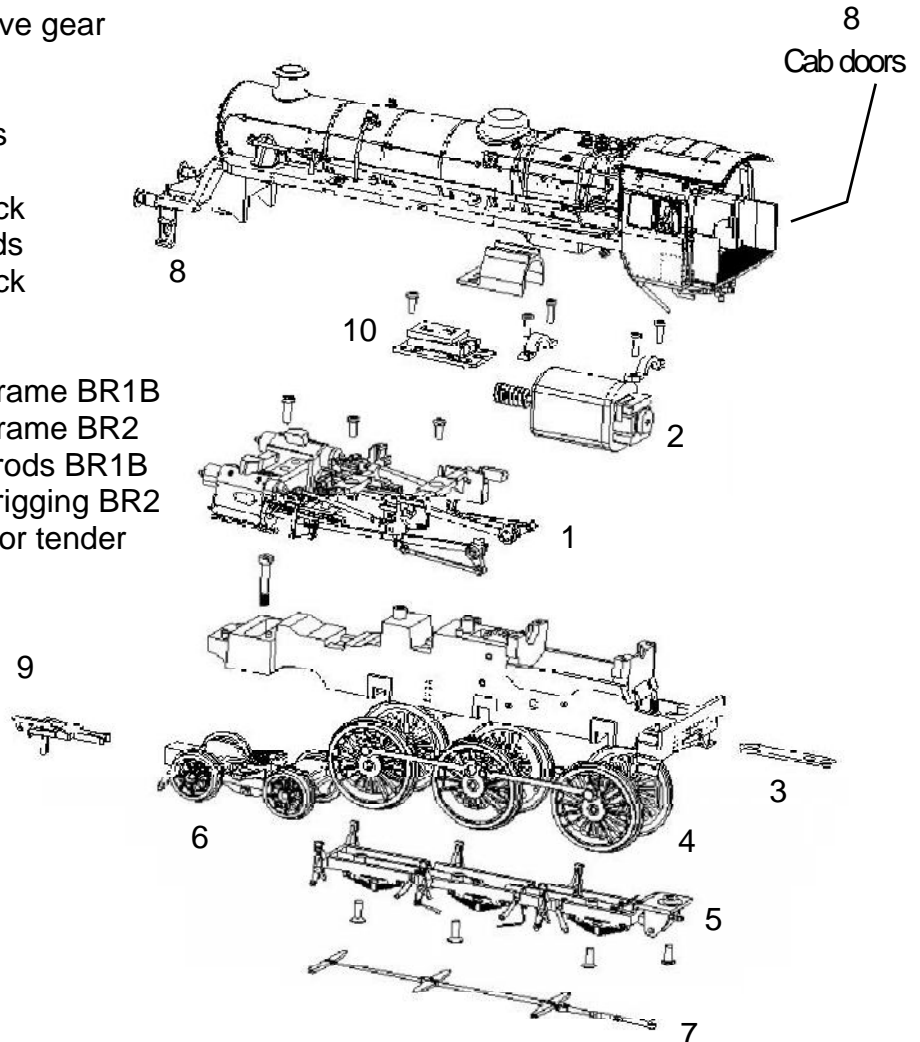

Replacement parts

When ordering parts please quote the catalogue number together with the livery of the model (if appropriate) and number of the part required.

Parts are subject to availability.

Packets of couplers (item 36-030) and buffers (item 36-032) suitable for this model are available from retailers.

Bachmann Europe Plc

Moat Way, Barwell, Leicestershire, LE9 8EY

01455 841756

www.bachmann.co.uk

BR 4MT 4-6-0 rev 1 05/08

E3111-ISO001