

Thank you for your choice of the Bachmann Branchline GNR Class C1 4-4-2 Atlantic locomotive.

Running in

The mechanism of this model requires running in (without a load) for approximately 1 hour in each direction at moderate speed.

Curves

Bachmann Branchline locomotives perform best on curves of second radius or greater (approx. 18 inches / 450 mm).

Bodyshell removal

Remove the screws as indicated on the diagram (right).

DCC Decoder fitting

This model has a 21-pin NEM655 mtc socket for a decoder. Remove the DC blanking plug and fit the decoder with the black fitting uppermost as shown.

We recommend that the running in as above be carried out using a DC power supply before moving on to fit a DCC decoder

Lubrication

When required, sparingly lubricate the motor bearings using plastic compatible light oil and the gear train with model grease.

DCC decoder fitting

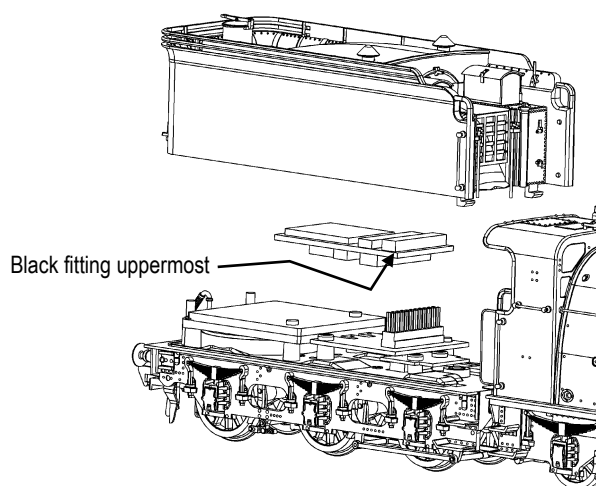

Bodyshell removal

Remove the indicated screws on loco and tender

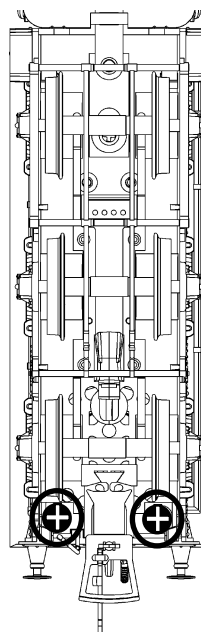
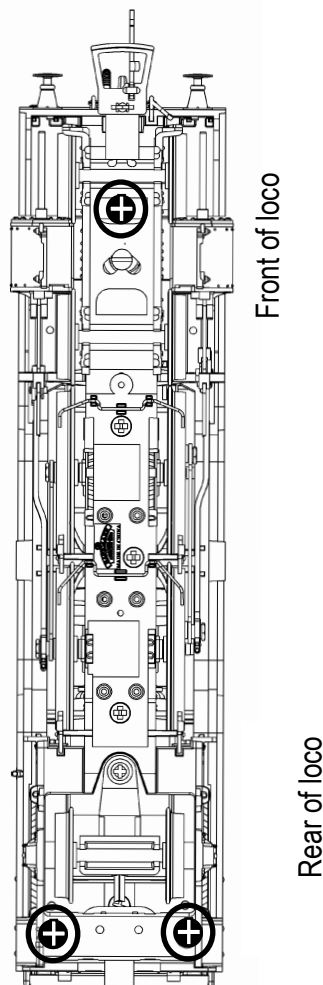

Bachmann Europe Plc

Moat Way, Barwell, Leicestershire, LE9 8EY
01455 841756

www.bachmann.co.uk

Class C1 rev 1 01/15 E3176-IS001

Remove weights if
speaker mount is to
be fitted

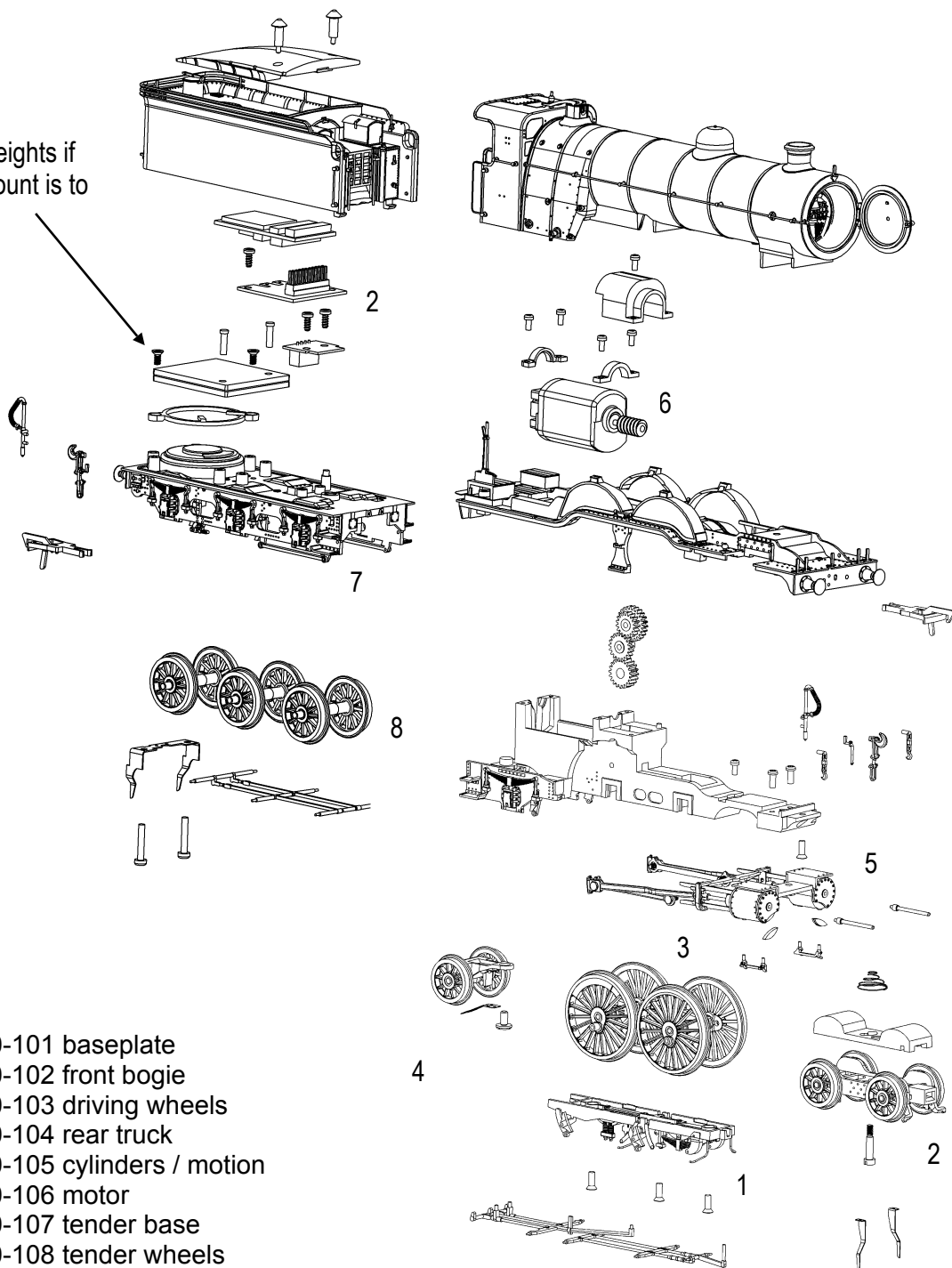

Parts

- | | |
|----|----------------------------|
| 1 | 760-101 baseplate |
| 2 | 760-102 front bogie |
| 3 | 760-103 driving wheels |
| 4 | 760-104 rear truck |
| 5 | 760-105 cylinders / motion |
| 6 | 760-106 motor |
| 7 | 760-107 tender base |
| 8 | 760-108 tender wheels |
| 9 | 760-109 gears |
| 10 | 760-110 PCB |

Replacement parts

When ordering parts please quote the catalogue number together with the livery of the model (if appropriate) and number of the part required.

Parts are subject to availability.

Packets of couplers (item 36-030) suitable for this model are available from retailers.

The model should be handled carefully as it has many finely detailed parts. It is not suitable for persons under 14 years.

GNR Livery (Preserved)

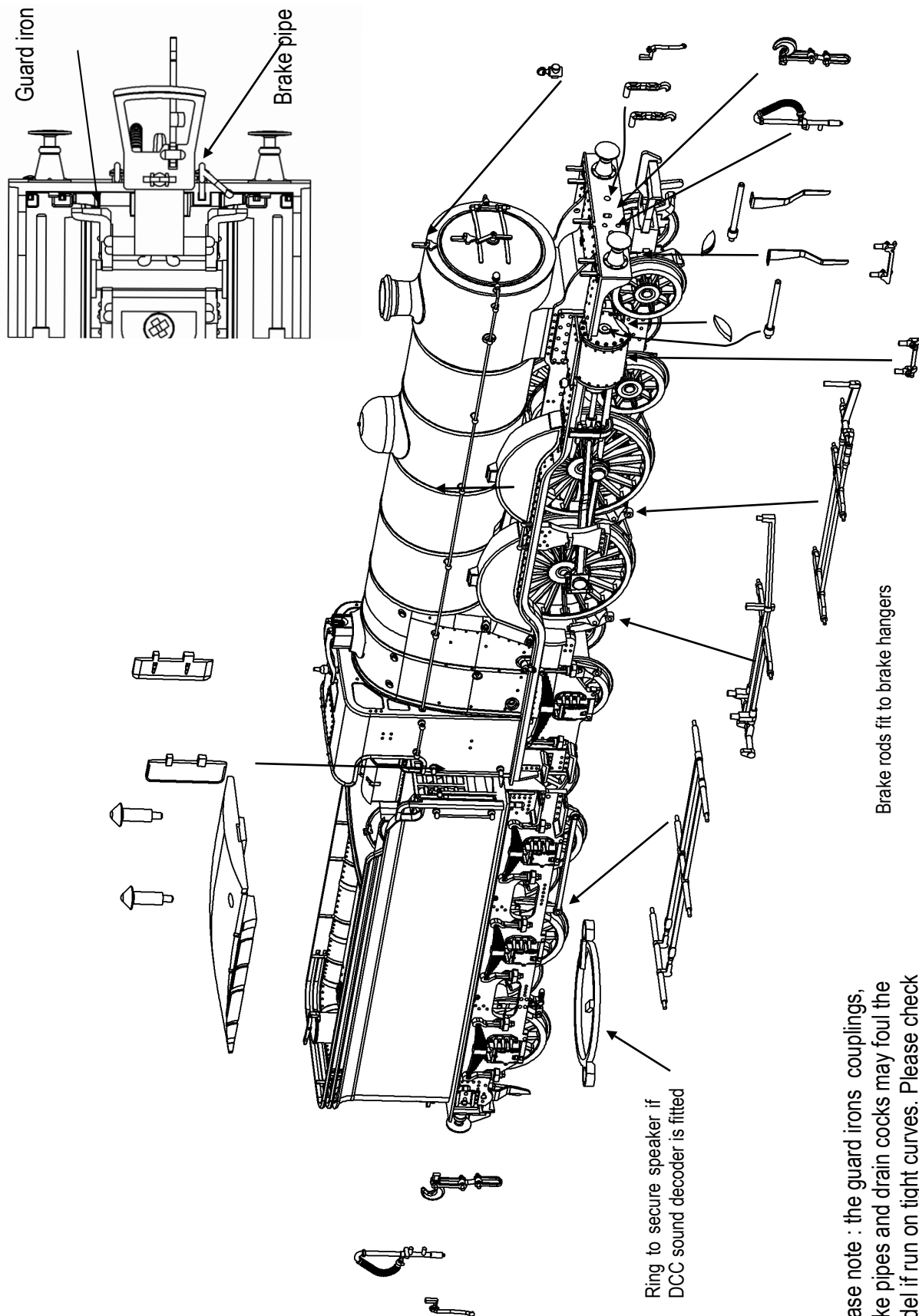

Please note : the guard irons couplings, brake pipes and drain cocks may foul the model if run on tight curves. Please check before final fitting

LNER Livery / BR Livery

