

Thank you for your choice of the Bachmann Branchline Metro-Cammell Class 101 diesel multiple unit.

## General

The mechanism of this model requires running in for approximately 1 hour in each direction at moderate speed to allow the gear train to bed in.

When required, sparingly lubricate the motor bearings using plastic compatible light oil and the gear train with model grease.

Bachmann Branchline locomotives are not suitable for use on track tighter than second radius (approx 18 inches)

## Body removal

Remove the four screws as indicated on the diagram - one in each corner of the unit - and ease the clips on either side as indicated \*. Use a length of thin stiff plastic inserted between body and solebar to assist.

## Location of buffer beam parts

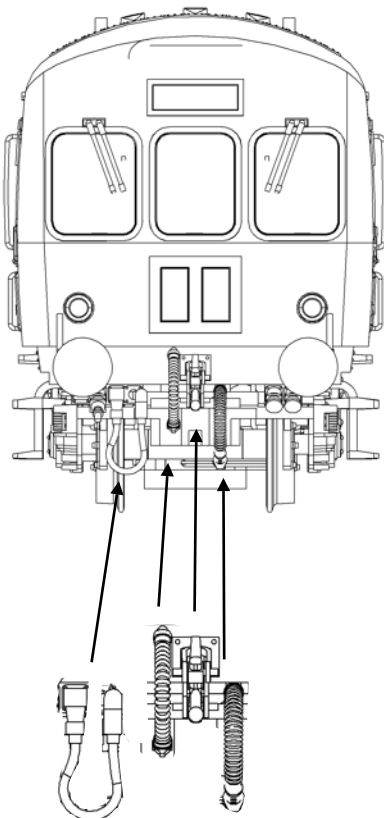

## DCC Decoder fitting to DC model

This model has a 21-pin mtc connector for a decoder in the power car.

It is recommended to run in a DC unit first on a DC power supply before installing a decoder.

Carefully remove the blanking plug and locate the decoder onto the pins on the PCB following the instructions included with the decoder: The decoder fits so that the black contact block is uppermost

## Control of lights

When using a DCC decoder the lights can be controlled as follows:

F0 - Head lights / tail lights and internal lights turned on / off

The interior lights can be turned on / off using the switch on the underside

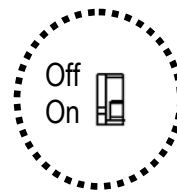

## DCC Sound decoder fitting to DC model

Remove the There are loudspeaker connections on the main PCB, marked 'SP+' and 'SP-' which can be used when a sound decoder with a 21-pin connector is used. Follow any fitting instructions supplied with the decoder. The speaker can be fitted to the underframe as indicated by removing the central block of seating (see over)

Remove blanking plug and fit decoder with black fitting uppermost

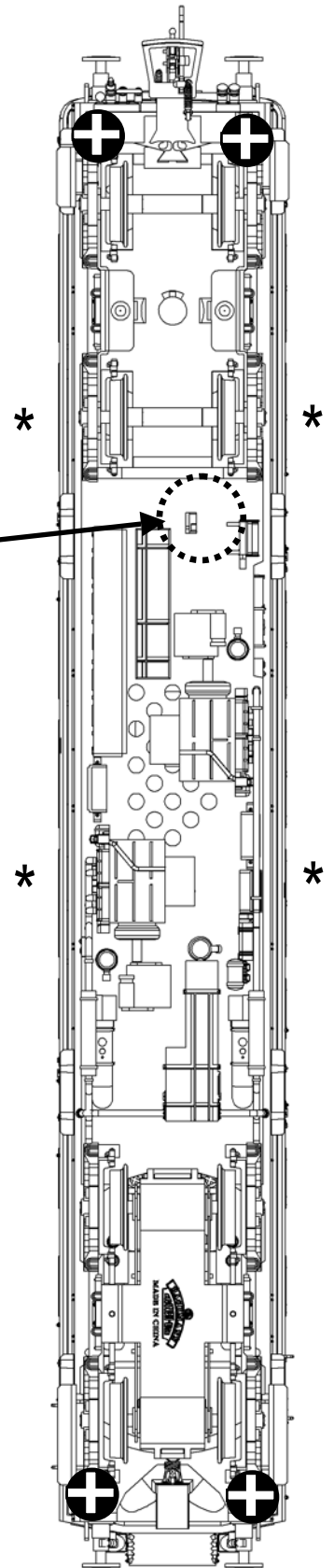
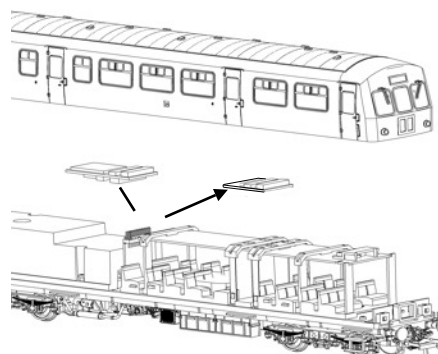

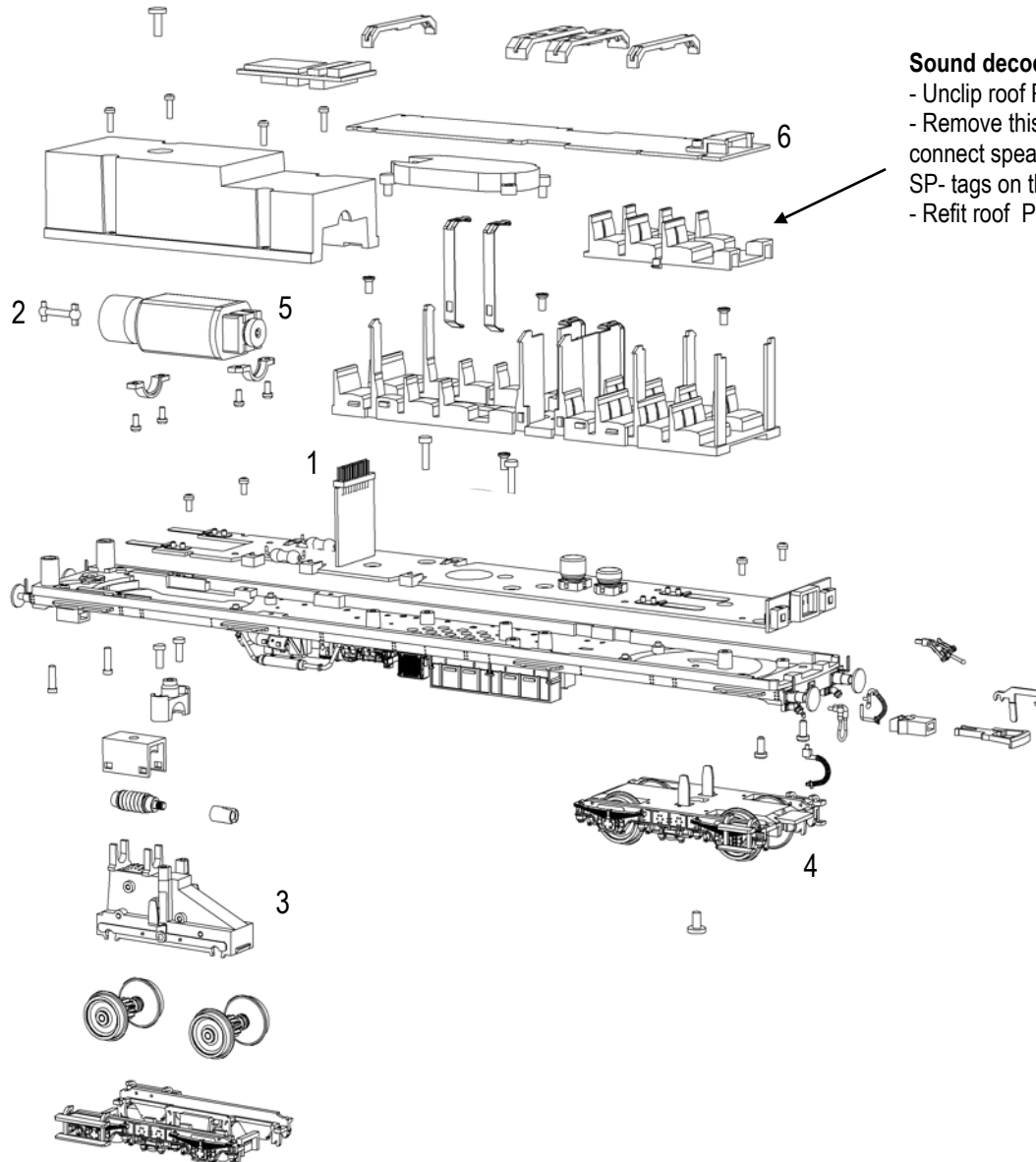
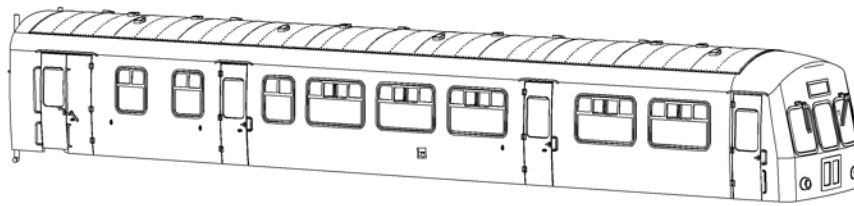

### Sound decoder / speaker fitting.

- Unclip roof PCB
- Remove this section of seating , connect speaker wires to SP+ and SP- tags on the PCB
- Refit roof PCB

### Replacement Parts

1	285-001	PCB 21pin
2	285-002	driveshaft
3	285-004	bogie - driven
4	285-004	bogie - unpowered
5	285-005	motor
6	285-006	LED board

When ordering parts please quote the catalogue number together with the livery of the model (if appropriate) and number of the part required.  
Parts are subject to availability.

Packets of couplers (item 36-030) suitable for this model are available from retailers

**The model should be handled carefully as it has many finely detailed parts. It is not suitable for persons under 14 years.**

**Bachmann Europe Plc**  
Moat Way  
Barwell  
Leicestershire  
LE9 8EY  
01455 841756  
www.bachmann.co.uk