

Thank you for your choice of the Graham Farish Class 20 diesel locomotive.

Running in

The mechanism of this model requires running in (without a load) for approximately 1 hour, in both directions, at moderate speed.

Curves

This locomotive is recommended for use on 10.5" radius curves but will operate on 9" radius curves.

Body removal

The bodysell is secured to the chassis by the screws in each corner of the body (see overleaf).

Lubrication

When required, sparingly lubricate the motor bearings using plastic compatible light oil and the gear train with model grease. Suitable lubricants are Bachmann E-Z Lube item 99984 or Woodland Scenics 'HobbyLube' Lite Oil item HL654.

DCC Decoder fitting

The model has a NMRA/NEM 651 6-pin decoder socket.

Follow the instructions supplied with the decoder. Remove the blanking board and fit the decoder, aligning to the pin markings shown on the PCB. We recommend that the model is run in first using a DC supply before fitting a decoder.

Buffer beam parts

Pipes and a cosmetic screw coupler can be fitted as an alternative to the functional coupler. The pipes and coupling fit in the order shown.

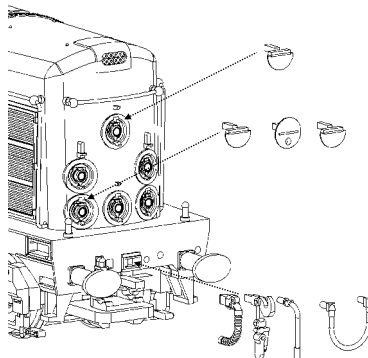

Graham Farish N scale models should not be run on a DCC supply unless a DCC decoder has been fitted as damage to the motor may result

Bachmann Europe Plc

Moat Way, Barwell, Leicestershire, LE9 8EY 01455 841756

www.bachmann.co.uk

Class 20 rev 1 04/12 F7130-IS001

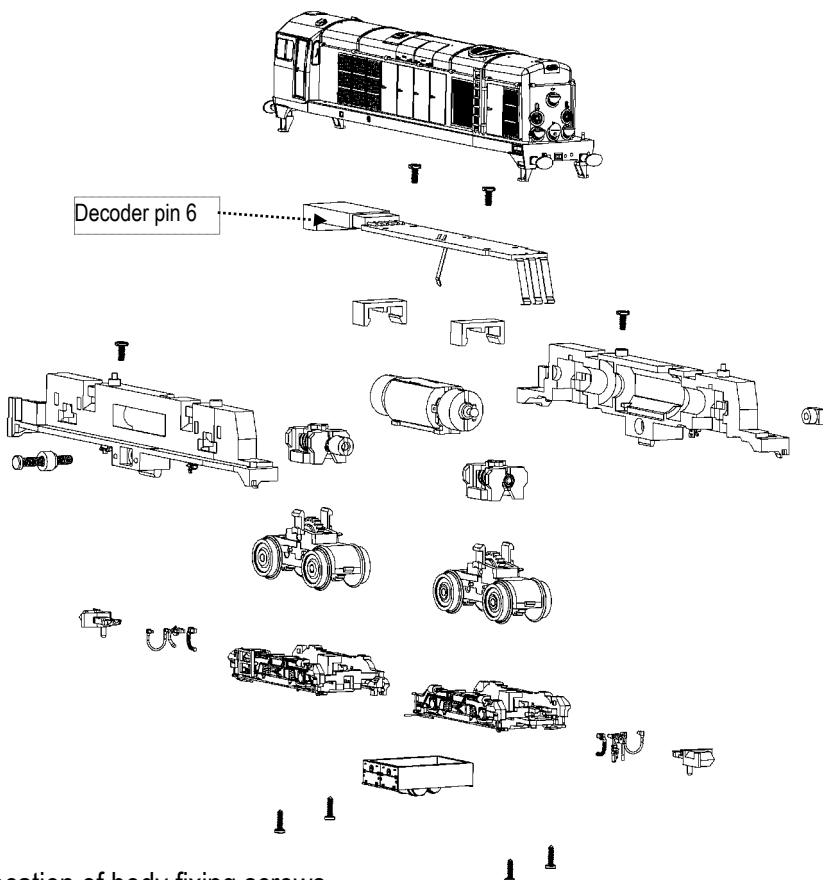

Location of body fixing screws

One screw in each corner

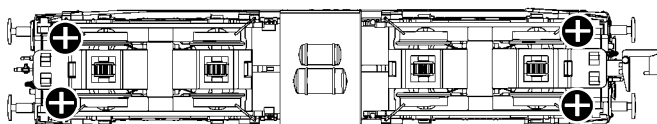

When ordering parts please quote the catalogue number together with the livery of the model (if appropriate) and indicate the part required.
Parts are subject to availability.

The model should be handled carefully as it has many finely detailed parts. It is not suitable for persons under 14 years

A selection of disc headcodes applicable to the Class 20 locomotive at different periods.

⊖ open disc ◐ closed disc

1960s

1970s



Express passenger
Postal. Newspaper



Ordinary / branch passenger



Fully brake fitted parcels /
perishables / ECS
Express freight brake fitted



Unfitted through freight



Part fitted express freight.



Part fitted freight



Unfitted express freight



Unfitted through freight



Freight, mineral or ballast stopping
at intermediate stations



Light engine



Express passenger
Postal. Newspaper

Ordinary / branch passenger

Express parcels

Parcels

Fully fitted express freight train

Part-fitted express freight train

Freight, mineral or ballast stopping at in-
termediate stations

Unfitted freight train.
Branch freight / freight stopping in section

Empty coaching stock

Light engine

