

Thank you for your choice of the Bachmann Branchline Siemens 'Desiro' Class 350 electric multiple unit.

General

The mechanism of this model requires running in (without a load) for approximately half an hour in each direction at moderate speed to allow the gear train to bed in.

When required, sparingly lubricate the motor bearings using plastic compatible light oil and the gear train with model grease.

Bachmann Branchline trains are not suitable for use on track tighter than second radius (18 inches).

Body removal

The power car body is secured by a screw in each of the 4 corners of the body plus a clip in the centre of the bodyside. Take care to avoid damage to the underfloor equipment details.

DCC Decoder fitting to DC model

This model has a 21-pin mtc connector for a decoder underneath the power car

It is recommended to run in a DC model first on a DC power supply before installing a decoder.

Carefully remove the blanking board and locate the decoder onto the pins on the PCB following the instructions included with the decoder: the decoder fits so that the black contact block is outermost.

Control of lights with DCC

When using a decoder with the appropriate number of function outputs, the onboard lights can be controlled as follows:

F0 - Directional lights turned on / off and
Interior lights on / off

Hints for best results

The operation of a DCC loco requires that the power to the model is not interrupted. Track, wheels and pickups should be kept clean and all rail joiners must give good connections between sections of track. Improved reliability of DCC performance may be obtained by deselecting DC operation of the model on the decoder. This is usually controlled by CV29, Bit 2

Order of cars

To ensure the correct operation of lighting the cars should be arranged in order A to D as labelled underneath each vehicle.

DCC Decoder / speaker fitting

The DCC decoder fits to the underneath of the unit as indicated after removal of the box (secured by one screw).

Take care when inserting / removing the blanking plug or decoder to avoid bending the pins. If necessary use an appropriate tool to grip the edges of the plug or decoder by the pin fitting and carefully ease the plug or decoder off the pins

A speaker for optional DCC sound operation can be fitted in the cradle in the box and connected to the two solder pads visible on the PCB

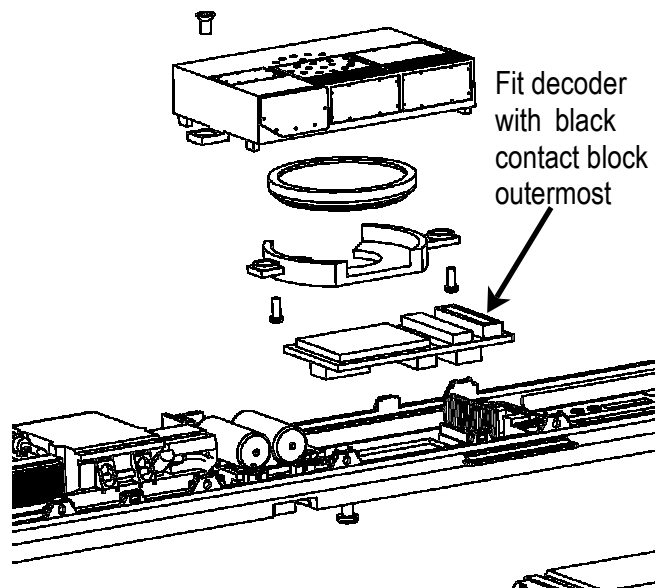

Cablights on/off

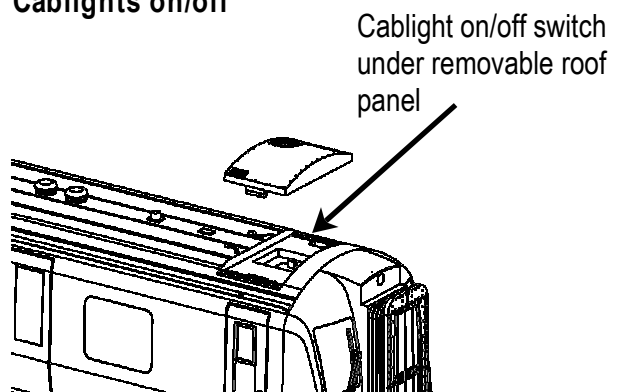

Replacement Parts

1	motor	030-101
2	PCB upper	030-102
3	driveshaft	030-103
4	bogie	030-104
5	drawbar	030-105
6	PCB lower	030-106

When ordering parts please quote the catalogue number together with the livery of the model (if appropriate) and number of the part required.

Parts are subject to availability.

Parts for this model available in retailer packs:

Couplings item ref 36-030

21 pin blanking plug item ref 36-058

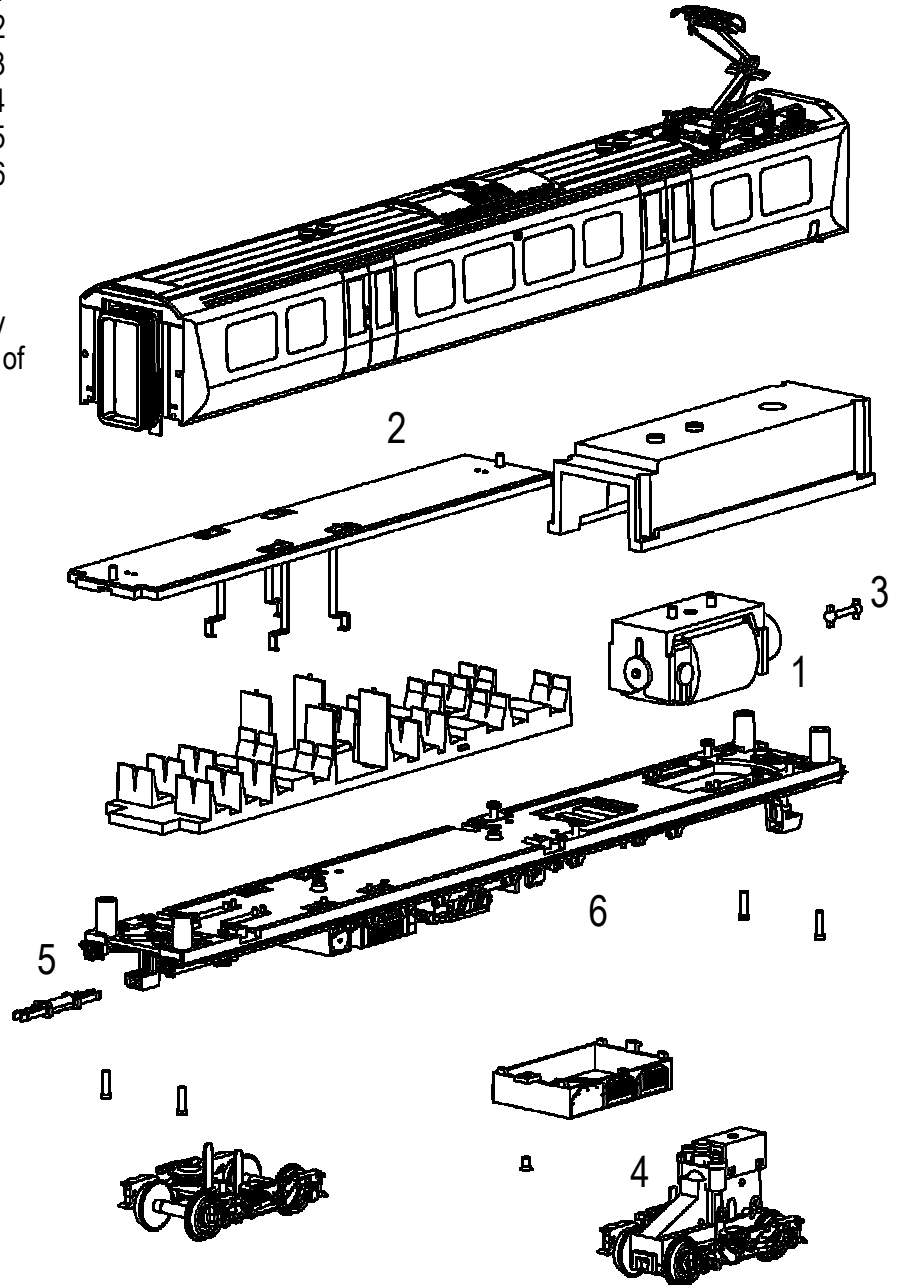

Bachmann Europe Plc

Moat Way

Barwell

Leicestershire

LE9 8EY

01455 841756

www.bachmann.co.uk

The model should be handled carefully as it has many finely detailed parts. It is not suitable for persons under 14 years.

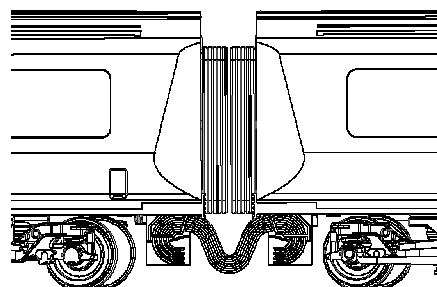

Cosmetic intercar power connectors suitable for static display models only