



# NBL Class 43 Warship B-B Diesel Locomotive

Thank you for your choice of the Bachmann Branchline Class 43 'Warship' diesel locomotive.

## General

The mechanism of this model requires running in (without a load) for approximately half an hour in each direction at moderate speed to allow the gear train to bed in.

When required, sparingly lubricate the motor bearings using plastic compatible light oil and the gear train with model grease.

Bachmann Branchline locomotives are not suitable for use on track tighter than second radius (18 inches).

## Body removal

There are two screws, on the diagonal beside each bogie, as indicated on the diagram

This screw secures the body, one located at each end of the loco

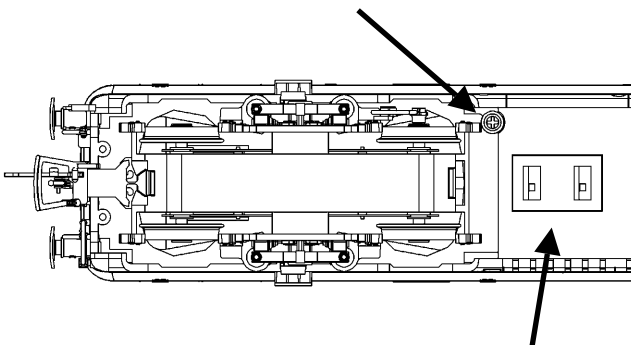

Switches for cab lights and tail lights on/off

## DCC Decoder fitting to DC model

This model has a 21-pin connector for a decoder.

Use either a decoder with matching fitting (for example Bachmann 36-554).

It is recommended to run a DC loco in first on a DC power supply before installing a decoder.

Carefully remove the blanking board and locate the decoder onto the pins on the PCB following the instructions included with the decoder: the decoder fits so that the contact block is uppermost with the decoder fitting towards the middle of the main loco PCB.

## Control of lights with DCC

When using a decoder with the appropriate number of function outputs, the onboard lights can be controlled as follows:

F0 - Head lights / tail lights turned on / off

F1 - Cab lights on / off

The model shows a yellow light on the leading and a red on the trailing end.

## Buffer beam parts

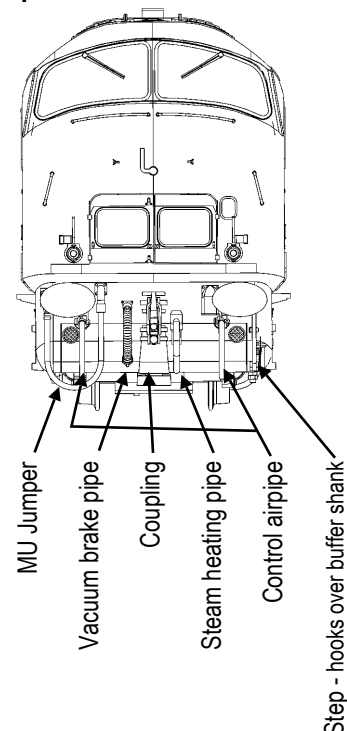

The fairing and buffer beam detail can be fitted only if the coupling is removed from the bogie.

## Hints for best results

The operation of a DCC loco requires that the power to the model is not interrupted. Track, wheels and pickups should be kept clean and all rail joiners must give good connections between sections of track. Improved reliability of DCC performance may be obtained by deselecting DC operation of the model on the decoder. This is usually controlled by CV29, Bit 2

DCC Onboard models include a blanking board should it be desired to run the model without a decoder.

## Replacement Parts

1	PCB 21pin	060-001
2	driveshaft	060-002
3	underframe	060-003
4	bogie	060-004
5	motor	060-005
6	motor bracket	060-006
7	buffer beam pack	060-007

When ordering parts please quote the catalogue number together with the livery of the model (if appropriate) and number of the part required.

Parts are subject to availability.

Packets of couplings suitable for this model are available from retailers: item ref 36-030

The decoder fits so that the contact block is uppermost

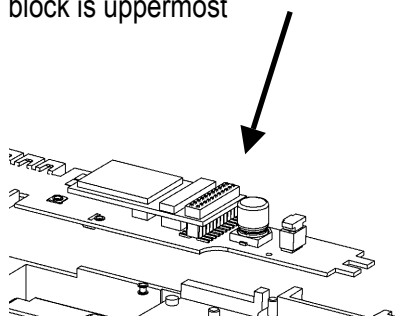

**The model should be handled carefully as it has many finely detailed parts. It is not suitable for persons under 14 years.**

**Bachmann Europe Plc**

Moat Way

Barwell

Leicestershire

LE9 8EY

01455 841756

[www.bachmann.co.uk](http://www.bachmann.co.uk)

E3206-IS001

05/15 Rev 1

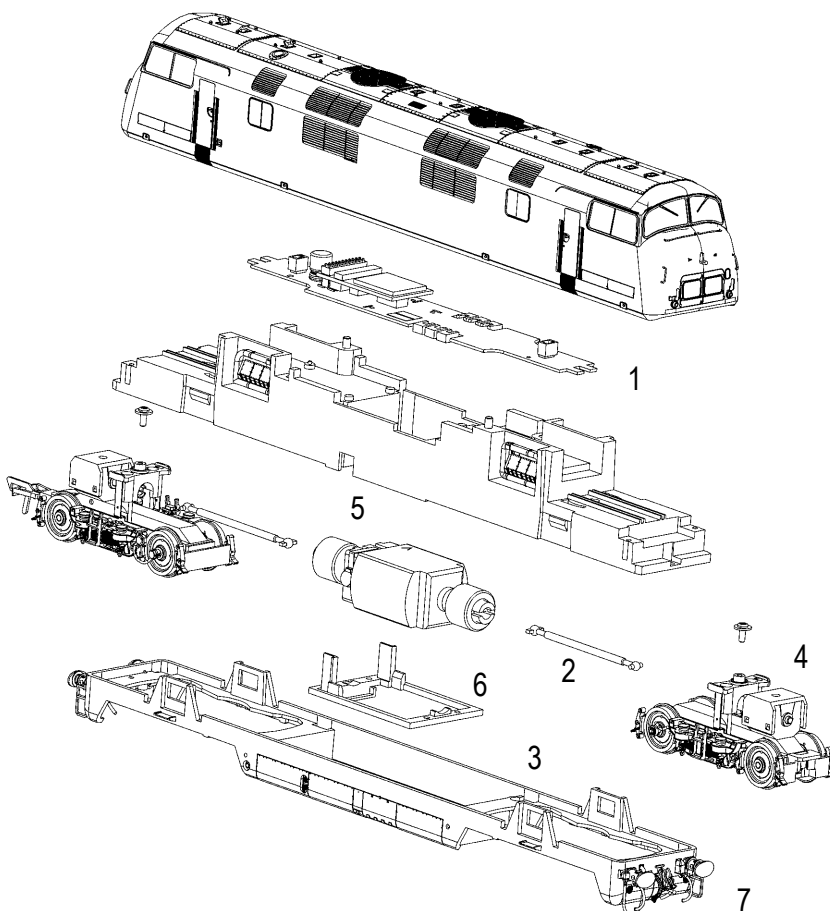

### Location of bogie steps

Either - Type A fit to the bogie (recommended for tight curves)

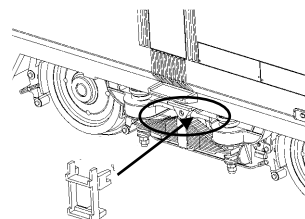

Or - Type B fit to the slots on the body underside (suitable for large radius curves only)

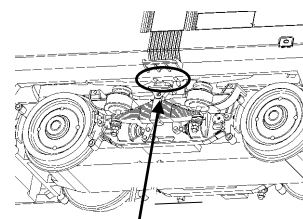

Vents (open or closed) and panel lifting eyes fit to roof

