

Thank you for your choice of the Graham Farish Fowler 4F 0-6-0 locomotive.

## Running in

The mechanism of this model requires running in (without a load) for approximately 1 hour in each direction at moderate speed.

## Curves

This locomotive performs best on track with curves of second radius (**approx. 10.5 inches / 260 mm**) or greater.

## Body removal

The loco and tender bodyshells unclip as shown overleaf

## Lubrication

When required, sparingly lubricate the motor bearings using plastic compatible light oil. Suitable lubricants are Bachmann E-Z Lube item 99984 or Woodland Scenics 'HobbyLube' Lite Oil item HL654.

## DCC Decoder fitting to non DCC fitted loco

This model has a 6-pin NEM651 socket in the tender for a decoder with a matching fitting eg Bachmann 36-558A decoder.

Run in as above using a DC power supply before fitting a DCC decoder; remove DC blanking plug from socket to fit decoder

## Accessory pack parts

If the loco has a Fowler tender - fit coal rails and tool holder

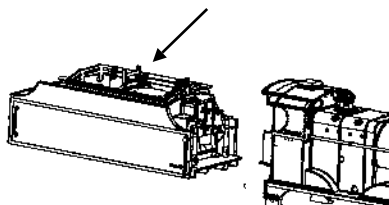

## All locos

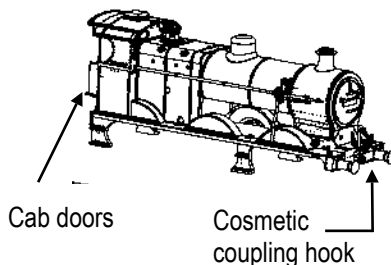

Align the decoder so that pin 1 matches the marks on the socket PCB

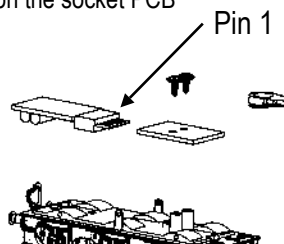

**Do not run Graham Farish N scale models with a DCC controller unless a DCC decoder has been fitted as damage to the motor may result if run as analogue loco "0"**

# Fowler Class 4F 0-6-0 locomotive

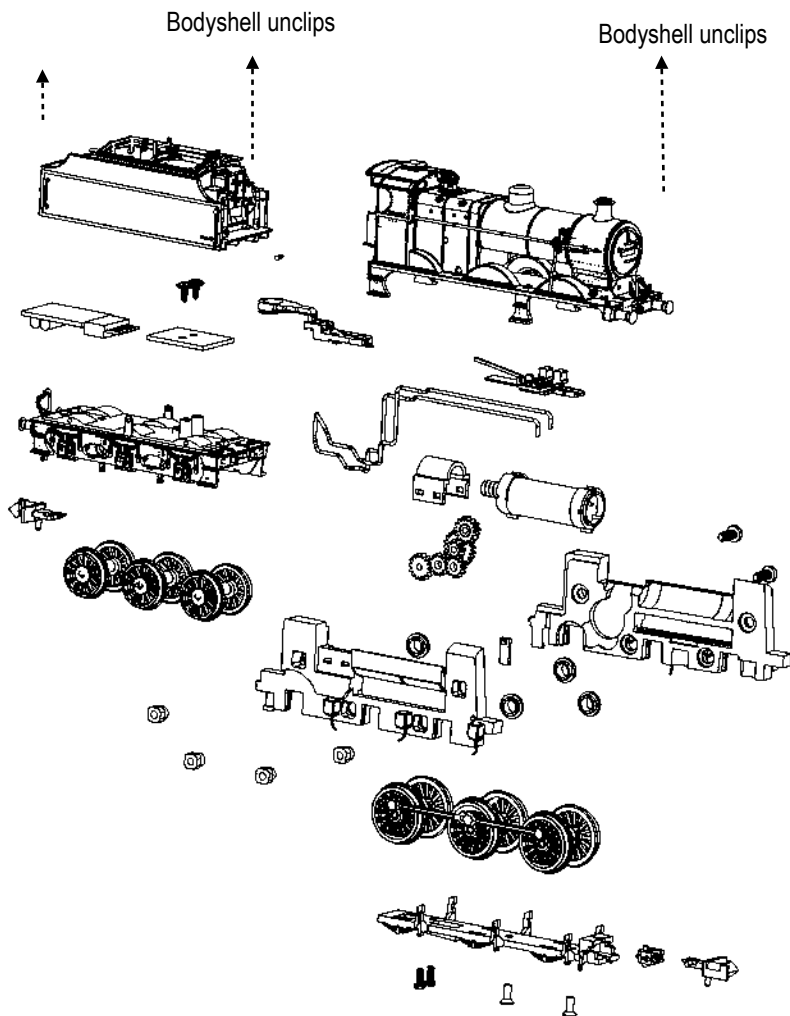

Parts subject to availability - please contact  
the Service Department  
Replacement parts available in retail packs  
Couplings - item 379-401

4F rev 2 07/14 F7206-IS001

© Bachmann Europe plc 2014

**Bachmann Europe Plc**

Moat Way, Barwell, Leicestershire,  
LE9 8EY

Tel: 01455 841756

[www.bachmann.co.uk](http://www.bachmann.co.uk)