

15-7-2005

To: Matthew Fong

Fm: Mr. Kong

E05-39

№ 4



CLASS 57 DIESEL LOCOMOTIVE PART DRAWINGS

Thank you for your choice of the Class 57 diesel locomotive.

The mechanism of this model requires running in (without a load) for approximately 1 hour in each direction at moderate speed to allow the gear train to bed in.

When required, sparingly lubricate the motor bearings using a plastic compatible light oil, and the gear train with a model grease.

Bachmann Branchline locomotives are not suitable for use on track tighter than 60 inches/second radius.

Body removal

Remove the screws indicated in the diagram.

DCC Decoder fitting

The model has a standard 8-pin NMRA/NEM decoder socket.

Run the model in first (as above) using a DC power supply before fitting the decoder.

Plug decoder into socket following the instructions included with the decoder. Pin 1 is marked on the circuit board. Secure the decoder with a self adhesive pad. Use a 1 amp rated decoder.

Placement parts

When ordering parts please quote the catalogue number and the livery of the model, and number of part required.

Parts are subject to availability.

Spare couplings and pockets for the model are available in retail packets.

The model should be handled carefully as it has many finely detailed parts. It is not suitable for persons under 14 years.

Bachmann Europe Plc
Moat Way, Barwell, Leics, LE9 8EY
01455 841756
www.bachmann.co.uk

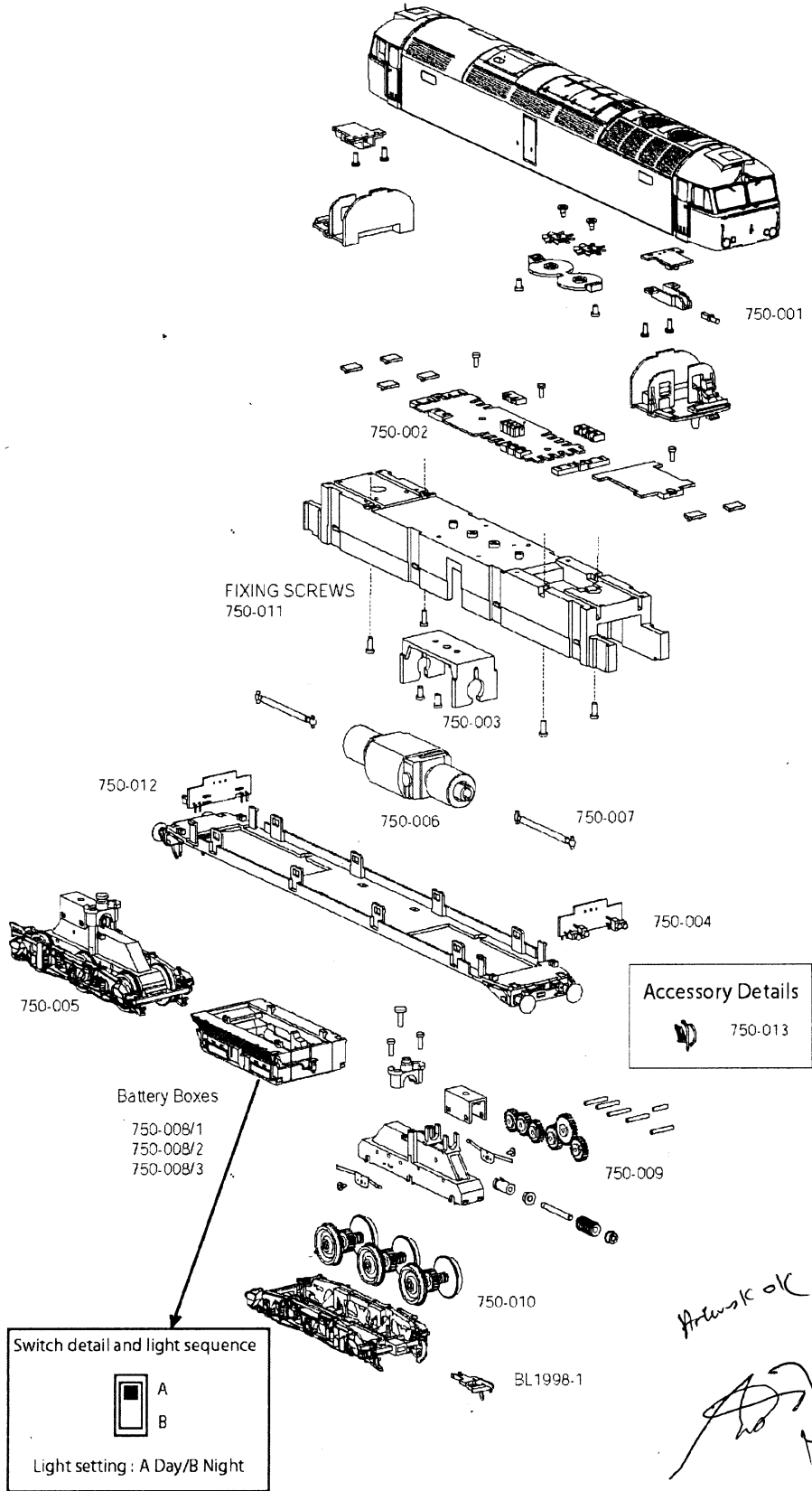

Accessory Details
750-013

Switch detail and light sequence

<input type="checkbox"/>	A
<input type="checkbox"/>	B

Light setting : A Day/B Night

Arrows ok
[Signature]

E3275-IS001

18 Jul 05

05.7.20