

Welcome

Many thanks for purchasing one of our **Bachmann Branchline** NER E1 (J72) Steam Locomotives. A lot of care was taken producing your model and we hope you enjoy it for many years to come.

Please note: This model has been designed to run on curves of **no less than 2nd Radius (438mm)**. We recommend that you don't use anything smaller as this may result in the model derailling.

1. Accessories

Although our models are highly detailed and ready to run straight from the box we also supply optional accessories to be fitted by the owner if they wish.

Please note: PVA based adhesive should be used for the fitting of accessories.

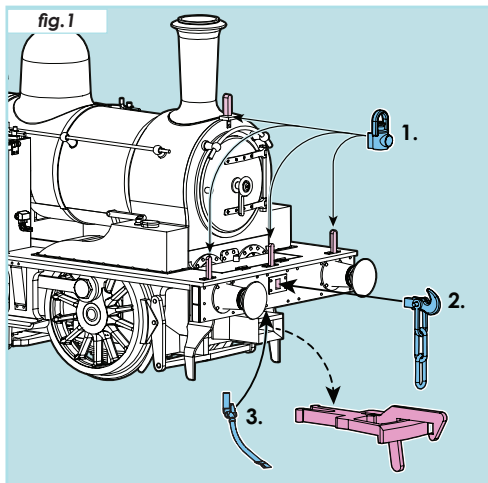

- 1 Oil Lamps (fit to both Front or Rear brackets at customer choice)
- 2 Screw-link Coupling*

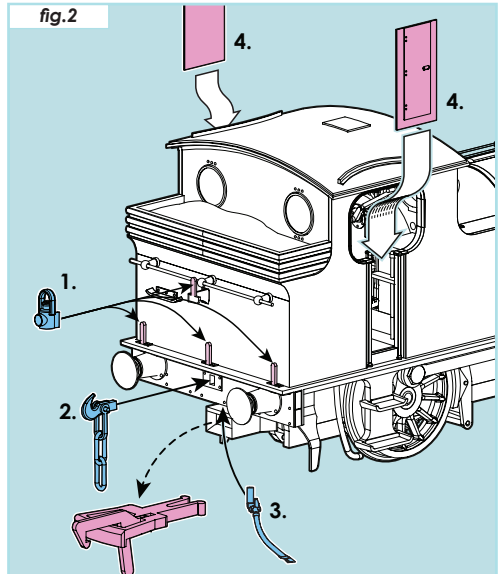

- 3 Steam Heat Pipe* - Only included with relevant models.
- 4 Cab Doors
- * Only fit if Standard Coupling has been removed.

2. Running-in

It is necessary that this Locomotive is 'run-in' to allow the mechanism and gears to settle. This requires the model to be run without a load (wagons, coaches, etc.) for 30 minutes in each direction at half speed.

3. Lubrication

All Bachmann Branchline Locomotives are supplied ready lubricated and can be used straight from the box. Over time your locomotive will require some additional lubrication, when will depend on the frequency of use and storage, so please inspect your model on a regular basis.

All moving parts of the connecting rods will occasionally need oiling. Apply a single drop of oil to the areas indicated in pink below (**fig.2**) and to the corresponding points on the other side.

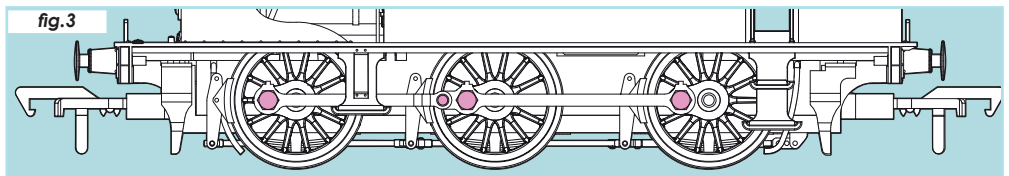

Lubrication - Continued.

fig.4

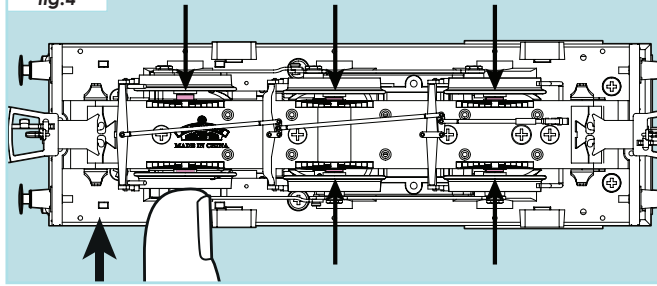

If the driving wheel axles appear dry and no lubricant is visible (where shown pink in fig.3), it would be advisable to lubricate your model.

Please note: A plastic compatible lubricant is required. Suitable products from both the Bachmann Trains & Woodland Scenics ranges are available from your local Bachmann retailer.

Motor Bearing Lubrication

The motor bearing comes ready lubricated, however depending on frequency of use over time they may require further lubrication. To access the motor bearings a small amount of disassembly is required and is shown below.

fig.5

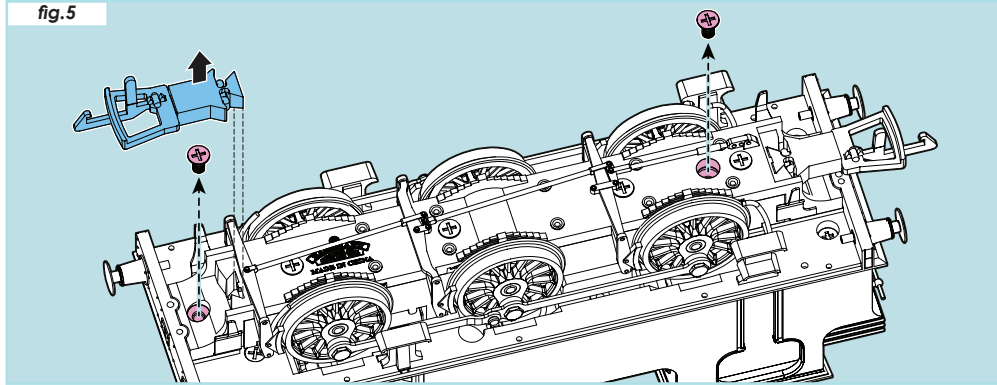

1. To remove the body first remove the Standard Coupling and Mount from the front of the locomotive. This can be easily prised out with a small flat head screwdriver. Then remove the two screws that secure the body to the chassis (fig.5).

2. Remove the body shell from the Chassis taking care not to damage any of the details (fig.6).

fig.6

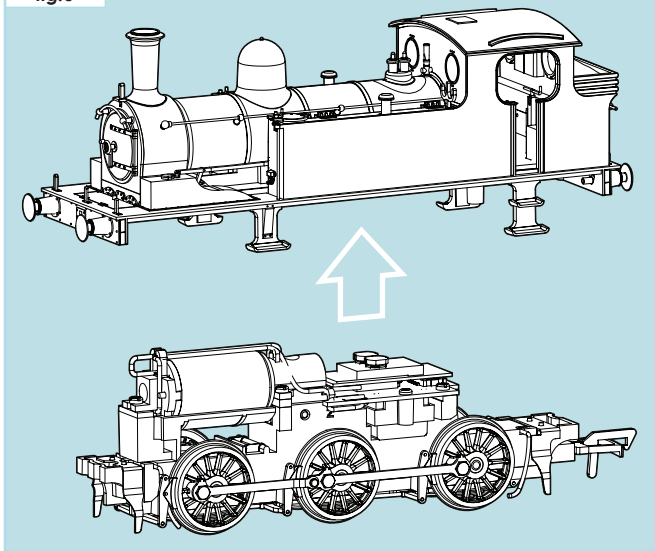

3. The Rear of the Motor Bearing will now be exposed, if it appears dry apply one drop of lubricant to it (fig.7).

4. To access the Front Motor Bearing you will need to remove the Motor Bearing Cover. Remove the two screws and gently lift, taking care not to damage the wires. (fig.8).

5. If it appears dry apply one drop of lubricant (fig.8).

fig.7

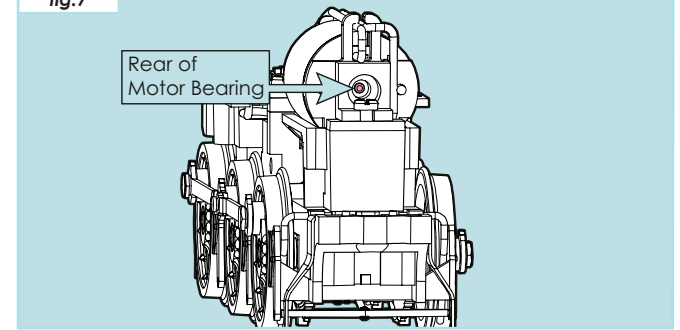
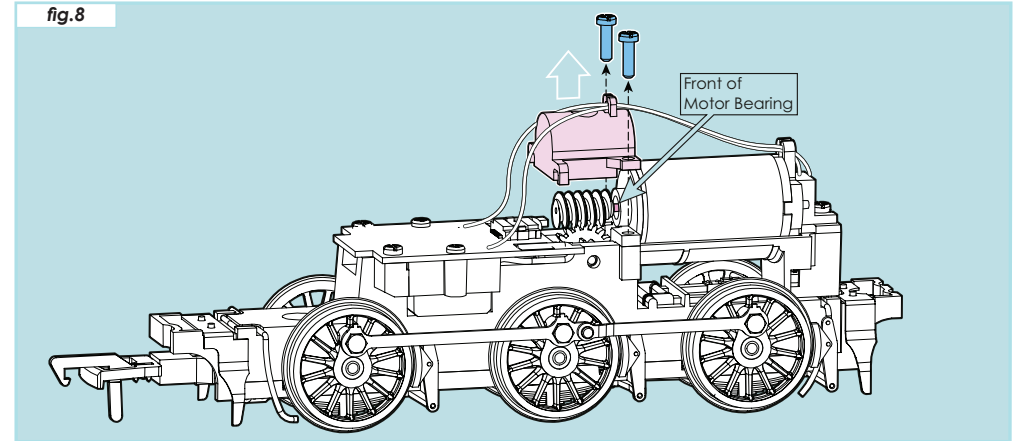

fig.8



4. DCC Decoder & Sound Decoder Fitting

Digital Command Control (DCC) allows for greater functionality and control over the models on your layout: such as the simultaneous control of speed & direction of multiple Locomotives and enables the use of DCC controlled track, points and other DCC Decoder fitted accessories. DCC also allows the addition of DCC Sound which brings a whole new level of realism to your model railway.

This NER E1 (J72) model comes with a factory fitted speaker, all that's required to bring Sound to your model is a Next18 DCC Sound Decoder pre-programmed with the sound file of your choice.

1. Remove the body shell as shown previously (figs.5 & 6)

2. Remove the Next18 Blanking Plate and push fit your Next18 DCC Decoder (fig.9)

fig.9

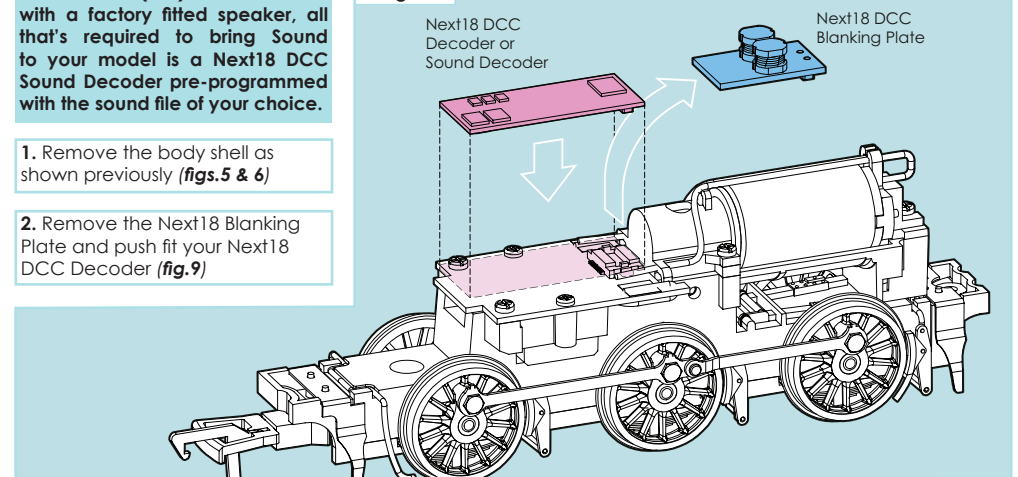

5. Firebox Glow & Flicker

The Bachmann NER E1 (J72) Steam Locomotive models have been factory fitted with two Firebox LEDs, one red and one yellow. On DC (analogue) operation with the factory fitted blanking plug the Red LED will be illuminated at a constant brightness (depending on controller setting).

To make use of both LEDs we suggest fitting 36-567 our Next18 DCC Decoder, with this decoder fitted the Red LED is controlled by Function Output 1 using the F1 key and the Yellow LED is controlled by Function Output 2 using the F2 key .

fig.10

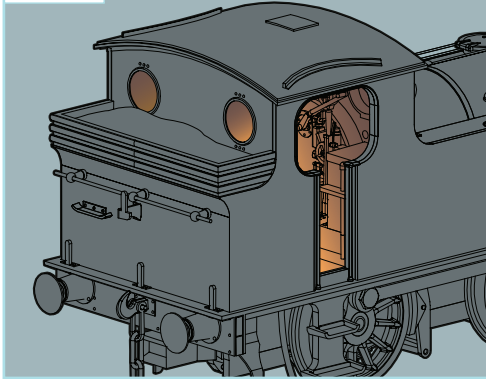

The default settings (of 0) for the two CVs that control these Functions illuminates the LEDs with a constant brightness. To simulate the effect of the glow/flicker given off by the fire, the value of the CVs for Function 1 & 2 (CVs 127 & 128 respectively) can be altered to give different lighting effects.

We suggest setting CV127 to a value of 8 would give a random flicker effect to the Red LED (Function 1), setting CV128 to a value of 8 would give a random flicker effect to the Yellow LED (Function 2).

Other effects are available, please refer to page 32, section 3.22 of ZIMO's 'Small' MX decoder manual available from www.zimo.at

6. Spare Parts

Selected spare parts are available from the Bachmann Europe Service Department. For further information and enquiries please contact the Service Department directly by email on service@bachmann-europe.co.uk or by phone **01455 245575**.

7. Warranty

This product has a Warranty for 12 months from the date of purchase against faulty materials or workmanship subject to the following conditions. During this period such defects that occur will be repaired or defective parts replaced free of charge.

1. This Warranty applies only if the item was purchased from an authorised retailer of Bachmann Europe PLC ('Bachmann') within the United Kingdom, European Union & European Economic Area. This Warranty does not confer any rights other than those expressly set out above and does not cover any claims for consequential loss or damage. The Warranty is offered as an additional benefit and does not affect your statutory rights as a consumer.

2. For claims under this Warranty, in the first instance the product must be returned to the retailer with evidence of the purchase date in the form of retailer receipt/invoice accompanied by a letter or Service Request form setting out the date and place of purchase, giving a brief explanation of the problem that has led to the claim. It is essential that the claim reach the retailer on or before the last day of this Warranty period. Late claims will not be considered.

3. This Warranty is only available to the original retail purchaser of this product and is non-transferable.

4. The Warranty does not extend to cover damage resulting from misuse or careless handling, accidental damage, wear and tear, or use on a voltage supply other than that stamped on the product.

5. The Warranty may be considered void if repairs have been attempted other than by Bachmann staff.

6. The Warranty is on the original product in its entirety and does not extend to individual components removed from the product. In respect of train sets the warranty applies to motorized units and controllers only.

7. If Bachmann chooses to replace a product it will be with the nearest appropriate model of its choice.

8. Bachmann reserves the right to decline service to any model that has been fitted with a decoder after manufacture.

9. Bachmann will not be held responsible for damage to or loss of an after market decoder fitted to a model submitted for service under the Warranty.

10. The fitting of a Bachmann decoder with a current Warranty shall not be deemed to change the position regarding a product that is otherwise outside its own Warranty. It may be necessary to change decoder settings during service.

11. Bachmann's liability under this Warranty will in no case exceed the price paid for the product as originally manufactured.



Bachmann Europe PLC

Moat Way, Barwell, Leicestershire, LE9 8EY, England.

www.bachmann.co.uk