

Accessories - Centre Head Code

The buffer beam pipes and fittings differ between Class 20/0 Disc and Centre Headcode variants, we have replicated this in our models and as such each type has a different set of buffer beam accessories.

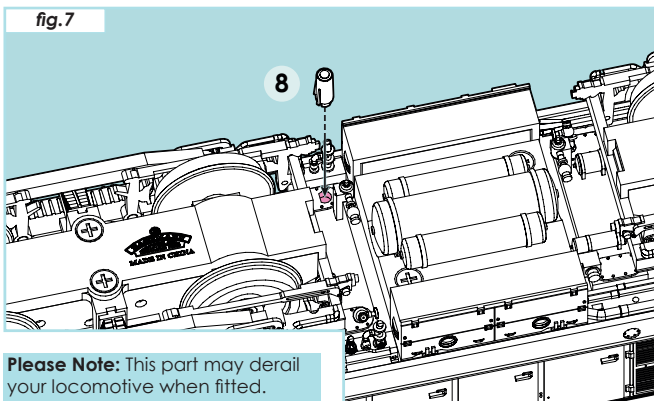

Please Note: This part may derail your locomotive when fitted.

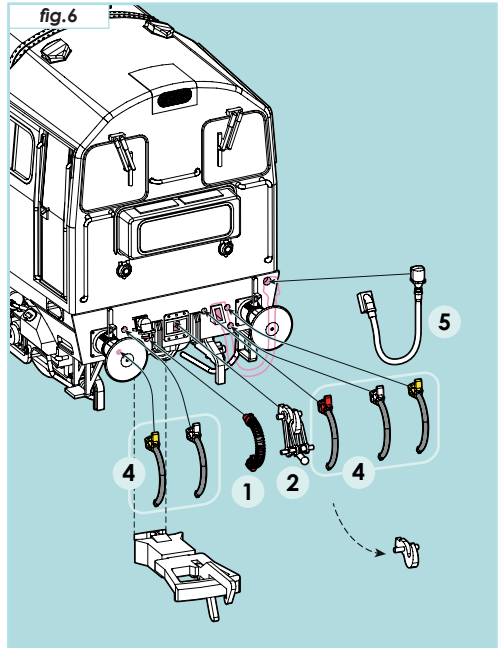
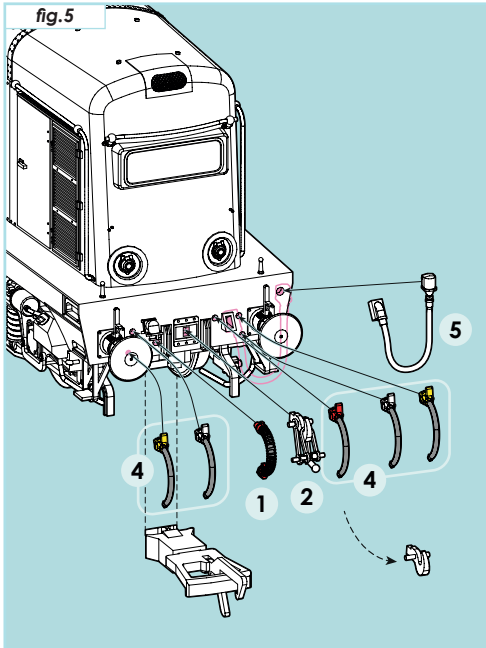
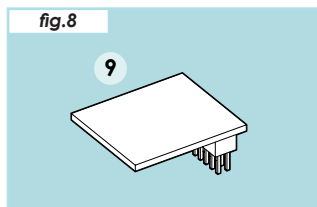

- 1 **Vacuum Brake Pipe***
 - 2 **Screw-link Couplings***
 - 4 **Buffer Beam Pipes***
Yellow - Engine Control Air Pipe
White - Air Pipe
Red - Air Brake Pipe
 - 5 **Multiple Working Cable***
 - 8 **Chassis Detail** (Static Display Only)
 - 9 **Plux22 DCC Blanking Plate**
Supplied with SOUND FITTED models only. Can be used to replace the Sound Decoder for use on analogue control without sound effects.
- * Only fit if Standard Coupling has been removed.**