

Accessories - Inner Bogie Sandboxes

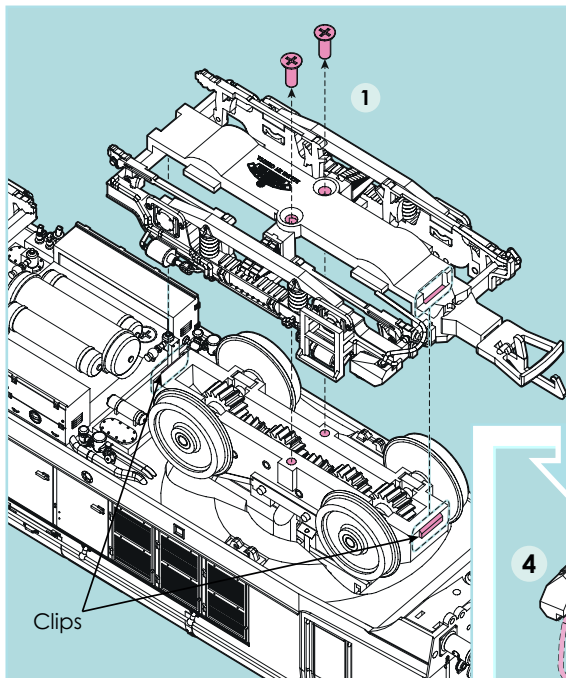

Some Class 20/0 locomotives were fitted with sandboxes on the inner edge of the Bogies. The Inner Bogie Sandbox accessories may only be included with models that represent prototypes with these fitted.

Please note: Fitting these may derail the locomotive we suggest they are for display purposes only.

1. First remove the bogie frame from underneath, these are held in place with two screws and some clips (**Fig. 9**).

2. Glue the mount to the inner of the bogie frame. (**Fig. 10**).

3. Fit the pipe detail wire into the small locating hole inside the outer sandbox part (**Fig. 10**).

4. Finally fit the outer sandbox and wire to the mount that's secured to the bogie (**Fig. 10**).

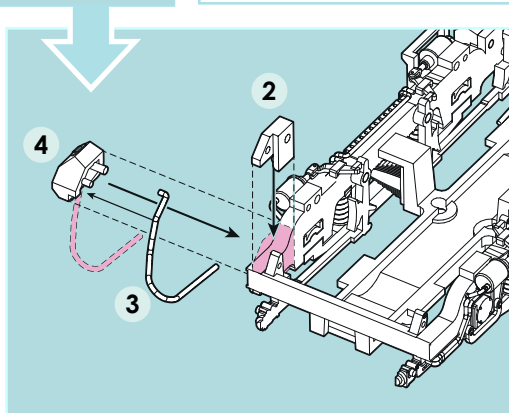

3. Running-in

It is necessary that this Locomotive is 'run-in' to allow the mechanism and gears to settle. This requires the model to be run without a load (wagons, coaches, etc.) for 30 minutes in each direction at half speed.

4. Lubrication

All Bachmann Branchline Locomotives are supplied ready lubricated and can be used straight from the box. Over time your locomotive will require some additional lubrication, when will depend on the frequency of use and storage, so please inspect your model on a regular basis.

If the driving wheel axles appear dry and no lubricant is visible (where shown pink in **fig.7**), it would be advisable to lubricate your model.

Please note:

A plastic compatible lubricant is required. We recommend the use of either **Bachmann Trains E-Z Lube Light Gear Oil 99984** or **Woodland Scenics Hob-E-Lube Lite Oil WHL654**.

