

Welcome

Many thanks for purchasing one of our **Graham Farish** BR Mk2F DBSO Coaches. A lot of care was taken producing your model and we hope you enjoy it for many years to come.

Please note: This model has been designed to run on curves of **no less than 2nd Radius** (263.5mm). We recommend that you don't use anything smaller as this may result in the model derailing.

1. Accessories

Although our models are highly detailed and ready to run straight from the box we also supply optional accessories to be fitted by the owner if they wish. Some of the accessories should only be fitted for static display as they may affect coupling or running quality, these parts will be labelled as such below.

Cab End (fig.1)

- 1 Brake Pipe*
 - 2 Main Reservoir Pipe*
 - 3 Dummy Coupling Hook
 - 4 Electric Train Heat (ETH) Socket
 - 5 ETH Cable
 - 6 Object Deflector*
 - 7 Corridor Connector Cover
- * Only fit if Standard Coupling has been removed.

fig.1

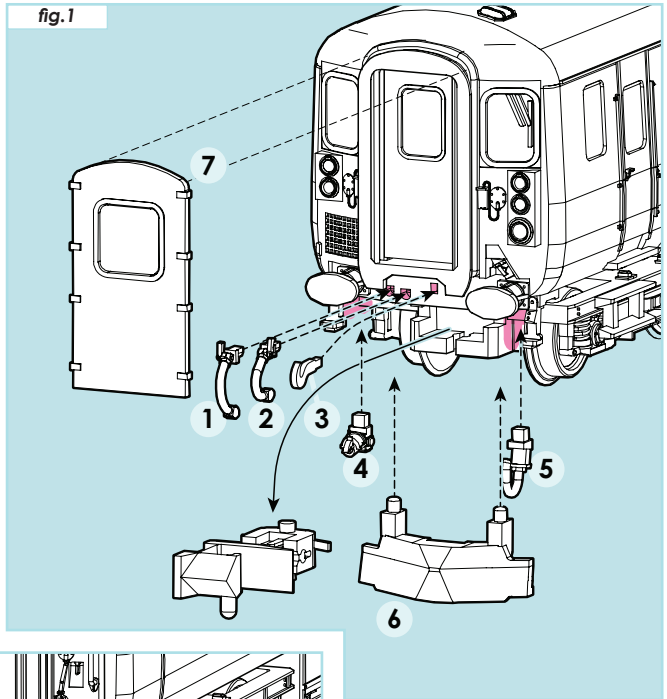

Please note: PVA based adhesive should be used for the fitting of accessories. This allows for the removal of an accessory without damaging the model.

fig.2

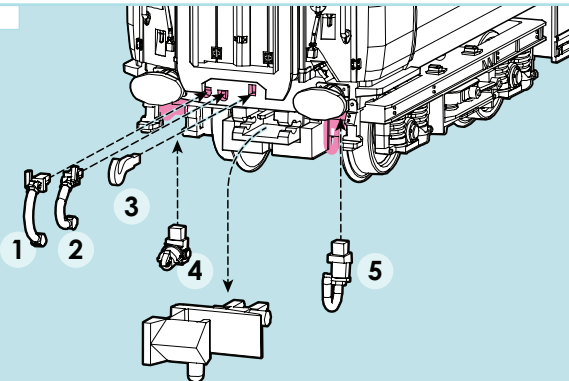

Corridor End (fig.2)

- 1 Brake Pipe*
 - 2 Main Reservoir Pipe*
 - 3 Dummy Coupling Hook
 - 4 Electric Train Heat (ETH) Socket
 - 5 ETH Cable
- * Only fit if Standard Coupling has been removed.

4. Fitting a Next18 DCC Decoder

The Graham Farish Mk2f DBSO is our first N Scale DCC Ready coach, fitting a Next18 DCC decoder will give you full control over directional lights.

fig.3

1. Remove the body shell by easing the bodysell out to release it from the chassis clips. (figs.3)

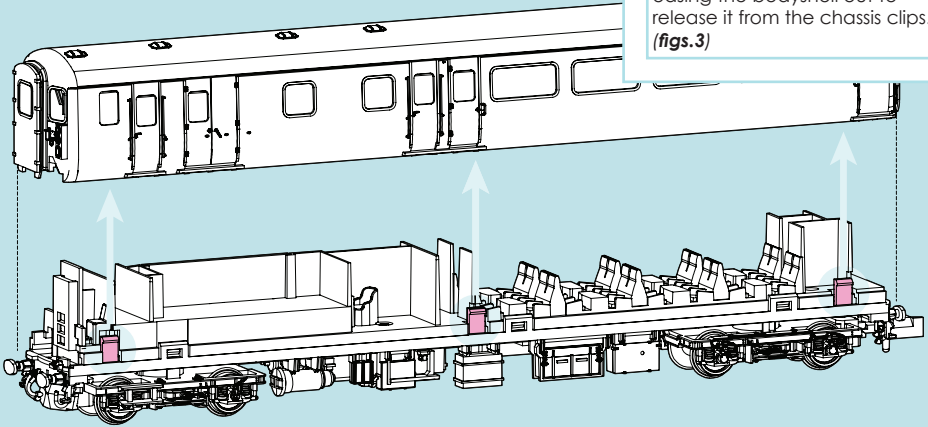

2. Remove the interior seating by easing the chassis tabs out to release. (figs.4)

fig.4

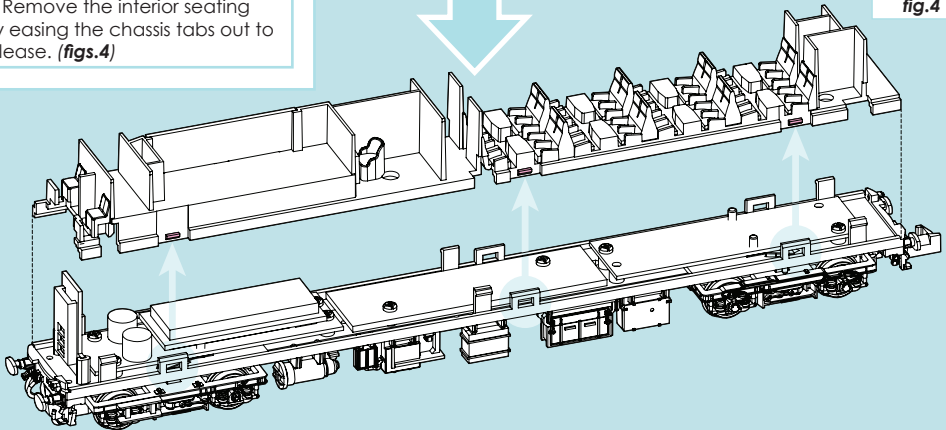

fig.5

Next18 DCC Decoder

Next18 DCC Blanking Plate

3. Remove the Next18 Blanking Plate and push fit your Next18 DCC Decoder (fig.5)

Once a Next18 Decoder has been fitted **F0** will control **Directional Lights**.

