

BR Autotrailer

Owner's Information

Although our models are highly detailed and ready to run straight from the box we also supply optional accessories to be fitted by the owner if they wish. **The standard coupling will need to be removed before fitting most of the accessories**

Please note: PVA based adhesive should be used for the fitting of accessories.

Cab front

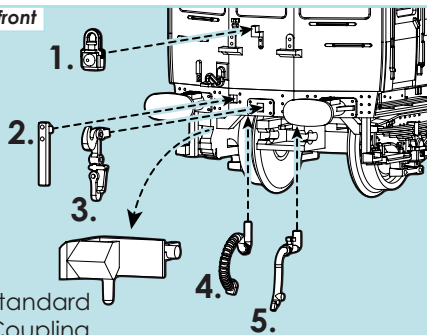

Rear

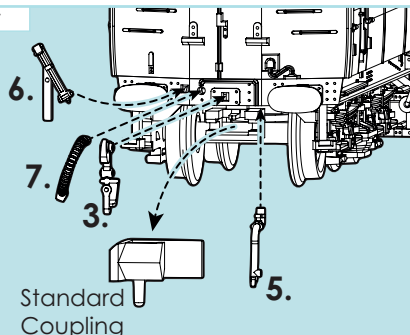

- 1 **Lamp** - Doesn't require the removal of the standard coupling.
- 2 **Vacuum Pipe Bracket (cab front)**
- 3 **Dummy Screwlink Coupling**
- 4 **Vacuum Pipe**

- 5 **Steam Pipe**
- 6 **Vacuum Pipe Bracket & Regulator Control Linkage**
- 7 **Vacuum Pipe (rear)**