

Thank you for your choice of the Bachmann Branchline Robinson J11 0-6-0 tender locomotive.

Running in

The mechanism of this model requires running in (without a load) for approximately one hour at moderate speed.

Curves

Bachmann Branchline locomotives perform best on curves of second radius or greater (approx. 18 inches / 450 mm).

Bodyshell removal

Remove the screws as indicated on the diagram .

DCC Decoder fitting

This model has an 21-pin socket in the tender for a decoder. Remove the DC blanking plug and fit the decoder to the pins with the black fitting uppermost. We recommend that the running in as above be carried out using a DC power supply before moving on to fit a DCC decoder. A loco with a factory fitted decoder will have an address of 03 can be run in on DCC.

Lubrication

When required, sparingly lubricate the motor bearings using plastic compatible light oil and the gear train with model grease.

Replacement parts

When ordering parts please quote the catalogue number together with the livery of the model (if appropriate) and number of the part required.

Parts are subject to availability.

Packets of couplers (item 36-030) suitable for this model are available from retailers.

The model should be handled carefully as it has many finely detailed parts. It is not suitable for persons under 14 years.

Bachmann Europe Plc

Moat Way, Barwell, Leicestershire, LE9 8EY
01455 841756

www.bachmann.co.uk

J11 rev 1 08/13

E3131-IS001

Bodyshell removal

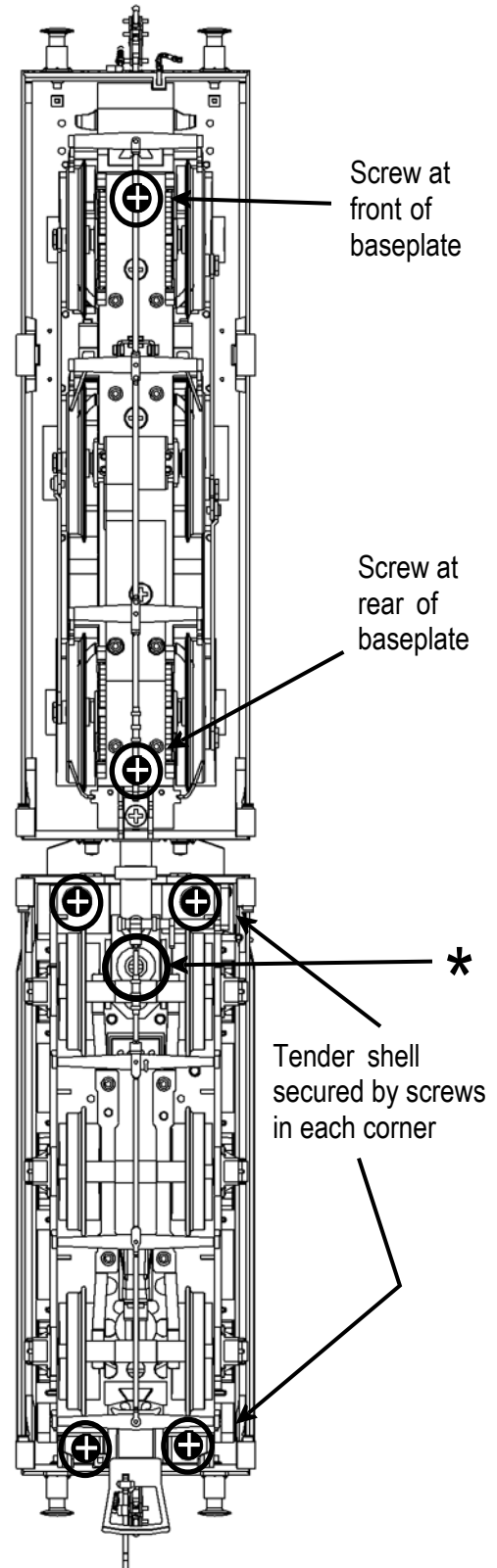

* Adjustable length tender draw bar is secured by the screw indicated - slacken a little to allow bar to slide

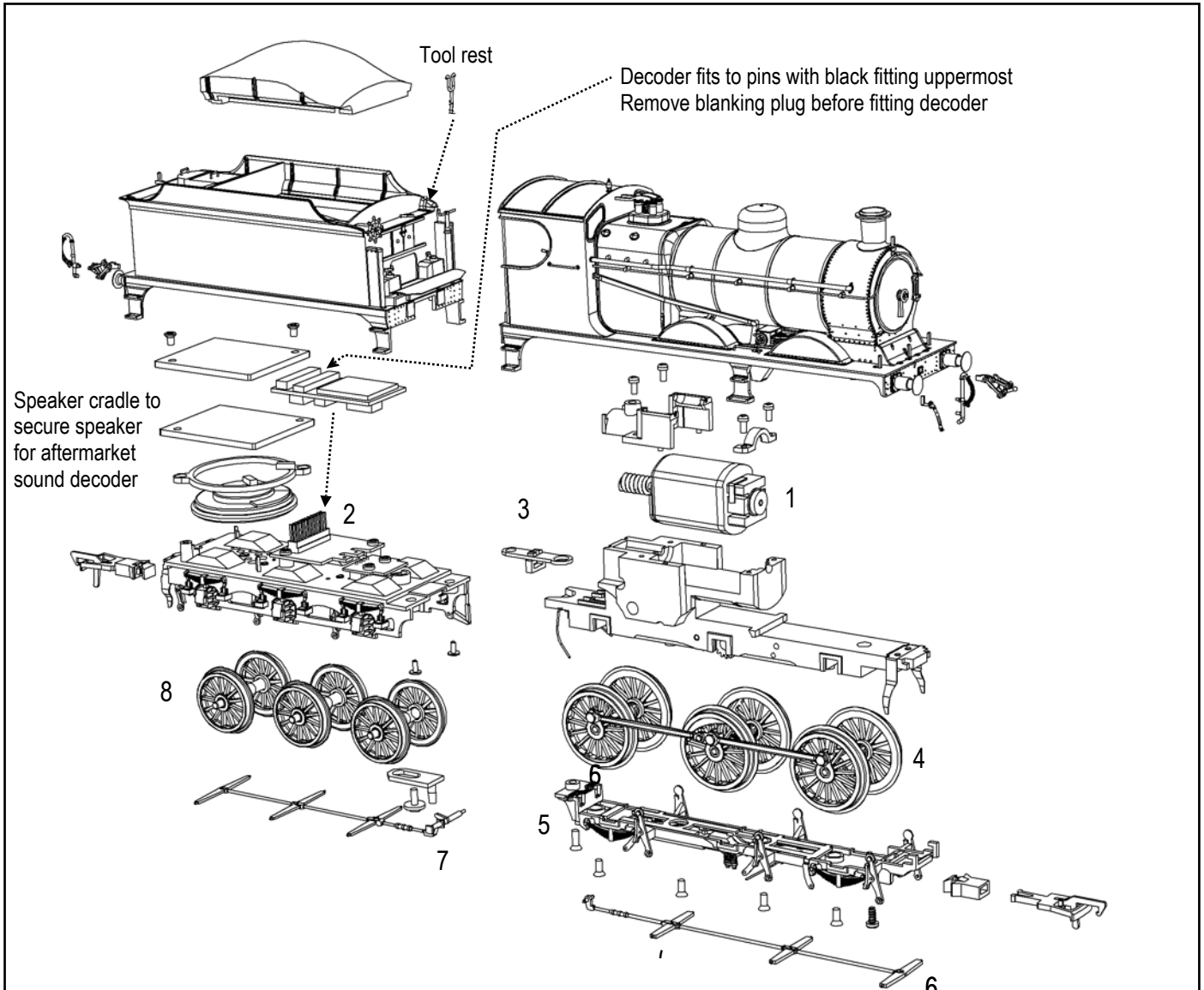

Location of cosmetic pipes and coupler

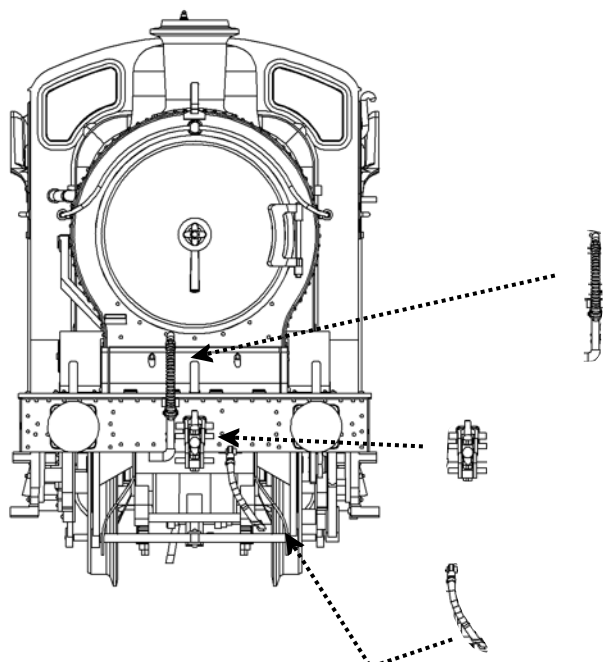

Parts

- 1 310-106 motor
- 2 310-004 circuit board
- 3 310-130 drawbar
- 4 310-117 driving wheels
- 5 310-118 baseplate
- 6 310-122 loco brake rigging
- 7 310-123 tender brake rigging
- 8 310-126 tender wheels