



# London Underground

## Parts

- 1 Motor
- 2 Driveshaft
- 3 Power car drive bogie
- 4 Power car trailer bogie
- 5 PCB power car A or B
- 6 Power car coupler
- 7 Trailer car coupler (clip)
- 8 Trailer car coupler 2

Also available  
Trailer car bogie

## Lubrication

From time to time if required  
apply a drop of plastic  
compatible model oil to the  
motor bears and geartrain in  
the locations indicated

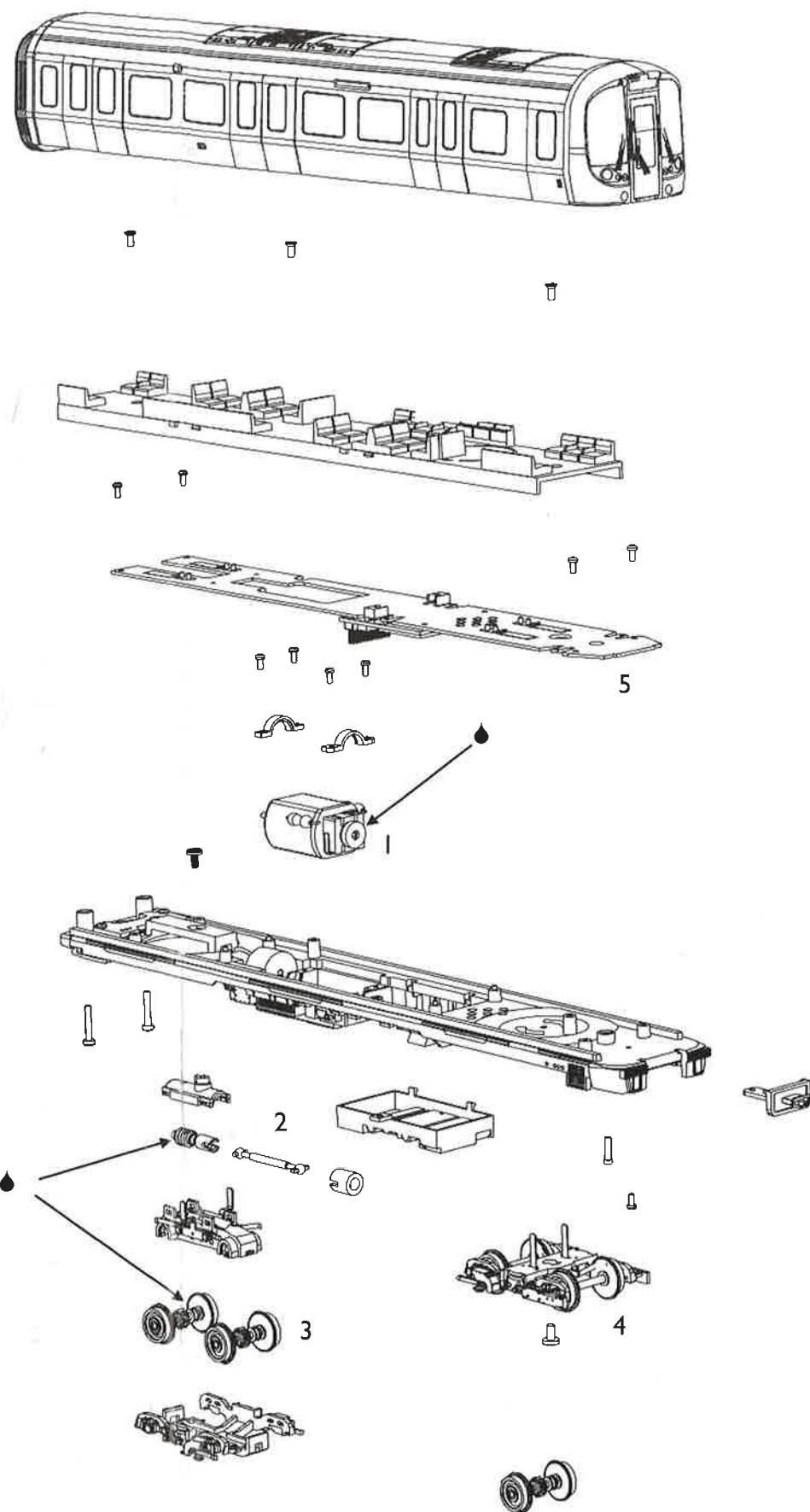

Wheelset with traction tyre supplied as  
an alternative to be fitted to power bogie  
should additional traction be required

## Bachmann Europe Plc

Moat Way, Barwell,  
Leicestershire, LE9 8EY  
01455 841756

[www.bachmann.co.uk](http://www.bachmann.co.uk)

S Stock rev I 02/15 E3599-IS001

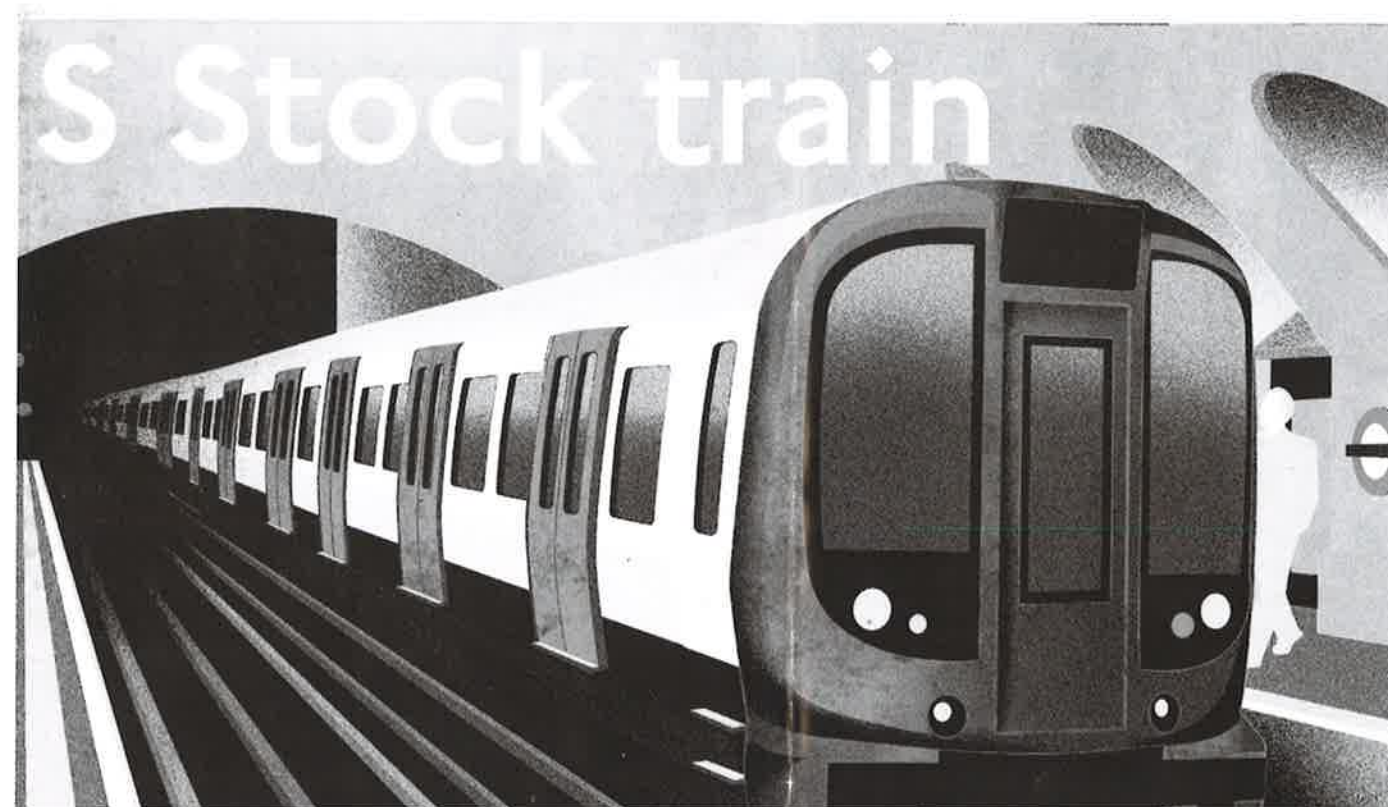

Illustration © Transport for London 2015

**General Information about the S Stock model train.**  
**Manufactured for London Transport Museum**  
[ltmuseumshop.co.uk](http://ltmuseumshop.co.uk)

Should experienced  
modellers wish to further  
detail the cars (add their  
own sound / lighting  
features etc) please note  
the following:

- seat component has a  
"break out" section (this  
will be a permanent  
modification)
- all bogies have electrical  
pick up
- front valance has  
removable centre section

Please note Bachmann  
Europe does not  
manufacture any other  
accessory items for the  
train

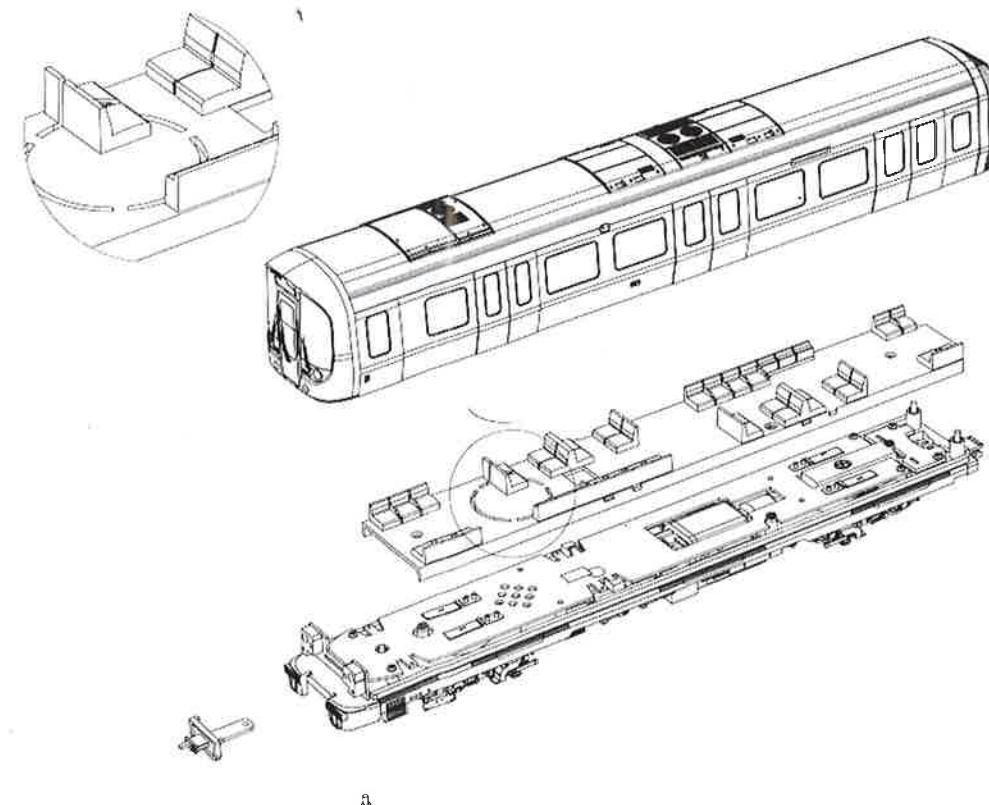



# London Underground S Stock Motorised 4 Car Train Pack

Thank you for your choice of the Bachmann Branchline London Underground S Stock 4 Car Train Pack. The model can be used on any OO / HO track with a conventional DC model train 12V controller

## Running in

The mechanism of this model requires running in for approximately 1 hour in both directions at moderate speed.

## Curves

Bachmann Branchline locomotives perform best on curves of second radius or greater (approx. 18 inches / 450 mm).

## DCC Decoder fitting

This model has a 21-pin NEM655 mtc socket for a decoder accessed by the removable panel under the powered car, one is required in each. We recommend that if possible the running in as above be completed using a DC power supply before moving on to fit a DCC decoder

## Coupling the cars

Place cars on track, align couplers and carefully push together until clip locates

## Uncoupling the cars

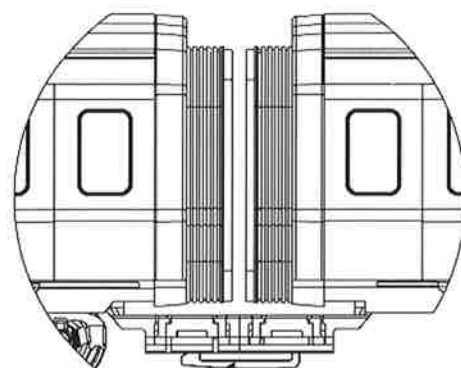

To uncouple insert coupling tool here and twist to unclip

## Fitting a DCC decoder

Release cover with screw indicated

Remove blanking plug

Fit decoder to pins with black fitting uppermost

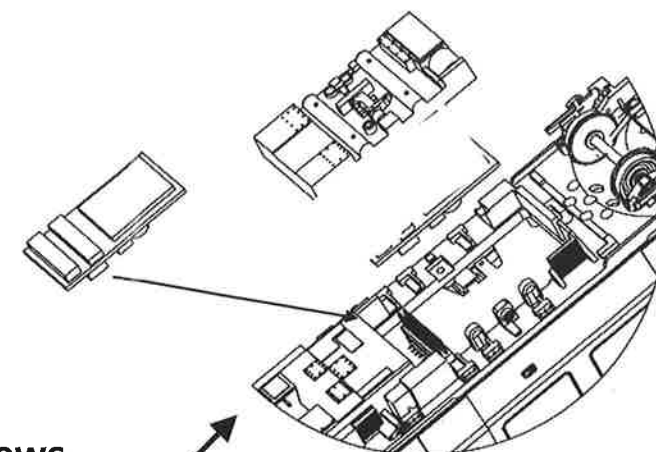

## Location of body securing screws

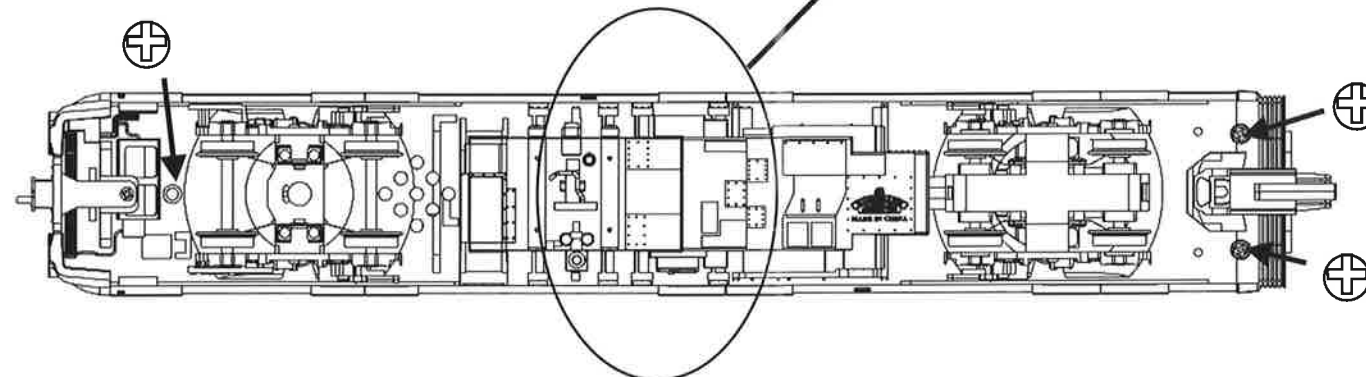

## Arrangement of the 4 cars of this train pack

