

Thank you for your choice of the Graham Farish BR Standard Class 4MT 2-6-4 tank locomotive.

Run in as above using a DC power supply before fitting a DCC decoder; remove DC blanking plug from socket to fit decoder

Running in

The mechanism of this model requires running in (without a load) for approximately 1 hour in each direction at moderate speed.

Curves

This locomotive will run on first radius track but performs best on track with curves of second radius (**approx. 10.5 inches / 260 mm**) or greater.

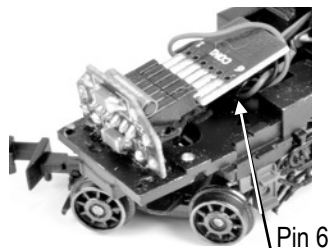

Location / alignment of blanking plug or decoder

Body removal

The bodyshell is secured by screw at the front of the baseplate and 2 under the baseplate as indicated right

Location of body screws

Lubrication

When required, sparingly lubricate the motor bearings using plastic compatible light oil. Suitable lubricants are Bachmann E-Z Lube item 99984 or Woodland Scenics 'HobbyLube' Lite Oil item HL654.

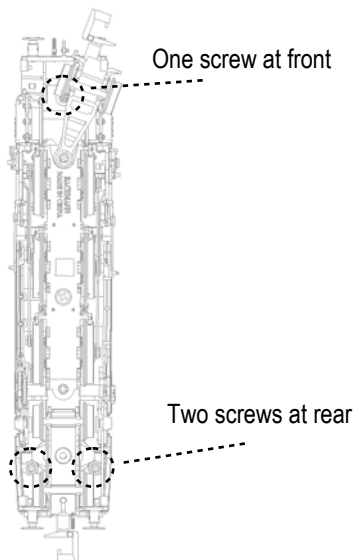

DCC Decoder fitting

This model has an 6-pin NEM651 socket in the cab area suitable for a decoder with an appropriate fitting eg Bachmann 36-558A decoder.

Do not run Graham Farish N scale models with a DCC controller unless a DCC decoder has been fitted as damage to the motor may result if run as analogue loco "0" (address 10 on E-Z Command)

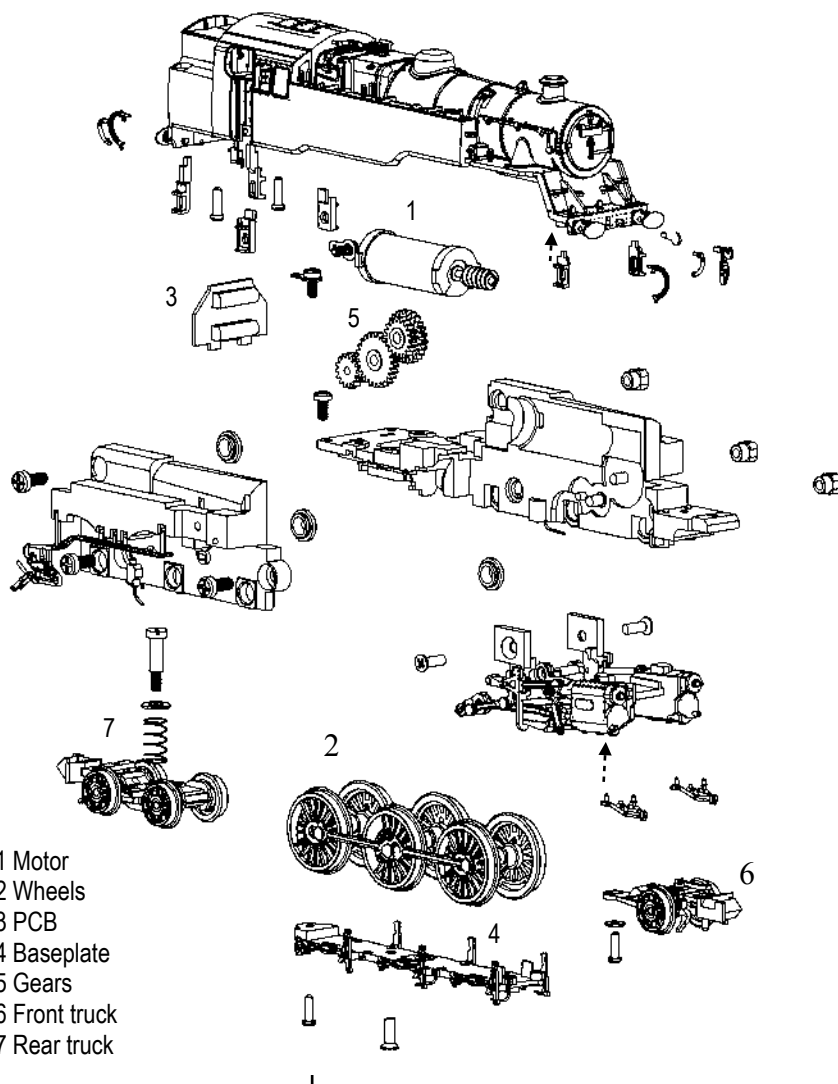

Parts subject to availability - please contact
the Service Department
Replacement parts available in retail packs
Couplings - item 379-401

Std 4 2-6-4 rev 1 12/15 F7253-IS001

© Bachmann Europe plc 2015

Bachmann Europe Plc

Moat Way, Barwell, Leicestershire,
LE9 8EY

Tel: 01455 841756

www.bachmann.co.uk