

5. DCC Sound - Installing DCC Sound (Continued)

fig.12

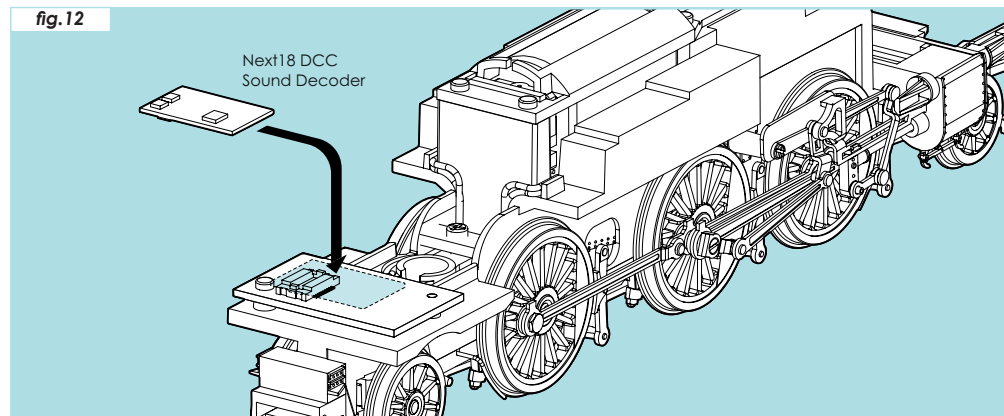

4. Push-fit the Next18 DCC Sound Decoder into the socket on the PCB board as shown.

6. Spare Parts

Selected spare parts are available from the Bachmann Europe service department, for further information and enquiries please contact the service dept. direct by email service@bachmann-europe.co.uk or by phone 01455 841756.

7. Warranty

Consumer Guarantee

This product is guaranteed for 12 months from the date of purchase against faulty materials or workmanship. During this period it will be repaired or have parts replaced free of charge provided that:

- The product is returned to Bachmann Europe plc with evidence of purchase date in accordance with the claims procedure outlined below.
- This product has not been misused or handled carelessly.
- Repairs have not been attempted other than by our service staff.

Claims procedure

Any claim made under this guarantee should be made directly to Bachmann Europe Plc. The claim itself should be made in a letter setting out the date and place of purchase and giving a brief explanation of the problem which has led to the claim. Enclose this letter with the product and proof of the purchase date (preferably a receipt) and send to: Bachmann Europe Plc, Moat Way, Barwell, Leicester, LE9 8EY.

Please note: it is essential that the letter of claim reaches the above address before the last day of this Guarantee. Late claims will not be considered.

This Guarantee applies to all goods purchased from an authorised retailer of Bachmann Europe plc within the United Kingdom of Great Britain and Northern Ireland. This Guarantee does not confer any rights other than those expressly set out above and does not cover any claims for consequential loss or damage. This Guarantee is offered as an extra benefit and does not affect your statutory rights as a consumer.

DCC Decoders

With the addition of DCC becoming commonplace, we are finding products being forwarded for repair with DCC Decoders installed. The fragile nature of these items means that they are susceptible to damage.

Please note: any locomotive returned to the Service Department for attention should, if possible, have any decoder removed. If sent with a decoder fitted please reset the address to 3, service may be restricted. Bachmann Europe plc only accept liability to the value of a standard model. This also applies to body modifications/detailing.

We will not be responsible for any loss or damage to any DCC items sent to us and they are likely to be returned to the sender with no action having been taken.



Class V1/V3 Tank Locomotive Owner's Information

Welcome

Many thanks for purchasing one of our **Bachmann Branchline** Class V1/V3 Tank Locomotives. A lot of care was taken producing your model and we hope you enjoy it for many years to come.

Please note: This model has been designed to run on curves of **no less than 2nd Radius (438mm)**. We recommend that you don't use anything smaller as this may result in the model derailing.

For best results don't use with Electronic Track Cleaners or Feedback Controllers.

1. Accessories

Although our models are highly detailed and ready to run straight from the box we also supply optional accessories to be fitted by the owner if they wish. Some of the accessories should only be fitted for static display as they may affect coupling or running quality, these parts will be labelled as such below.

Please note: Cyanoacrylate (super glue) must be used for the fitting of accessories.

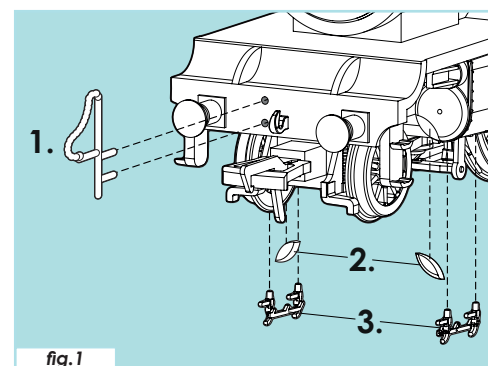

- fig.1
- 1 Vacuum Brake Pipes
 - 2 Cylinder Draincocks
 - 3 Cylinder Corner In-fill

- use only on 3rd radius (505mm) curves or larger.
- use only on 3rd radius (505mm) curves or larger.

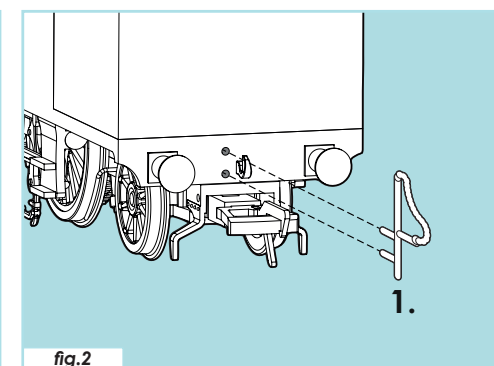

fig.2

2. Running-in

It is necessary that this locomotive is 'run-in' to allow the mechanism and gears to settle. This requires the model to be run without a load (wagons, coaches, etc.) for 30mins in each direction at half speed.

3. Lubrication

All Bachmann Branchline locomotives are supplied ready lubricated and can be used straight from the box. Over time your locomotive will require some additional lubrication, when will depend on the frequency of use and storage so please inspect your model on a regular basis.

If the driving wheel axles appear dry and no lubricant is visible, (where shown pink **fig.3**) it would be advisable to lubricate your model.

Please note: A plastic compatible lubricant is required. Suitable products from both the Bachmann Trains & Woodland Scenics ranges are available from your local Bachmann retailer.

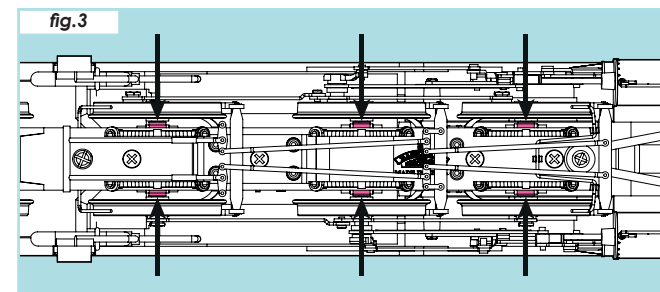

3. Lubrication (Continued)

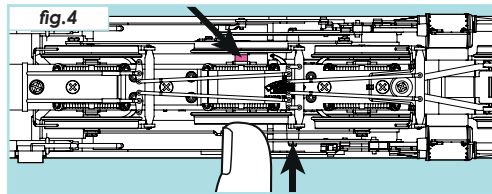

The driving wheel bearings will require lubricating at both ends, to do this simply push the set of wheels to one side and apply a single drop of plastic compatible lubricant to the exposed axle. Then repeat on the other side.

Motor Bearing Lubrication

The motor bearings will also require lubricating. A small amount of disassembly is required and is shown in **figure 6, 7 & 8.**

Begin by removing the body (**fig.6**).

If the motor bearing shaft appears dry, apply one drop of lubricant to each end of the shaft. (Shown in pink in **Fig. 7 & 8**)

Rear Motor Bearing Lubrication.

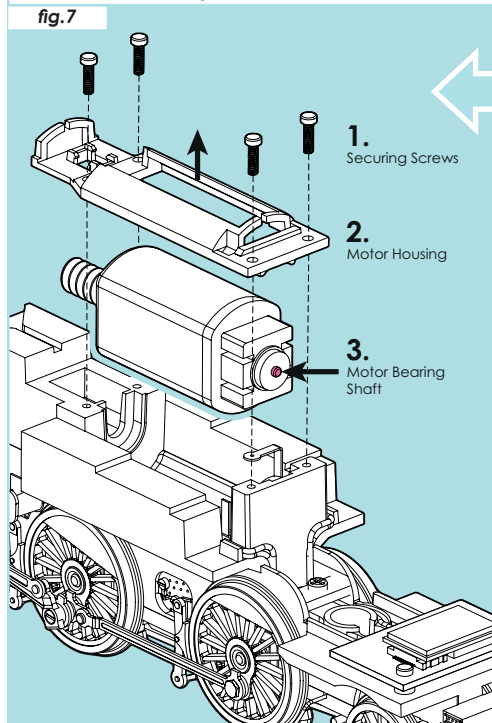

1. Remove securing screws & motor housing.
2. Lift the motor from the cradle.
3. Lubricate the rear end of the motor bearing shaft.

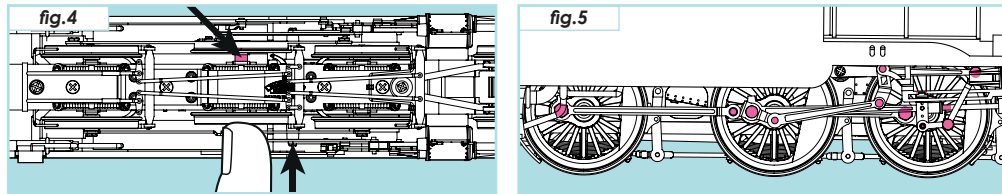

Oiling will also be required to all moving parts of the connecting rods and valve gear. Apply a single drop of oil to the areas indicated in pink above (**fig.5**) and the corresponding points on the other side.

fig.6

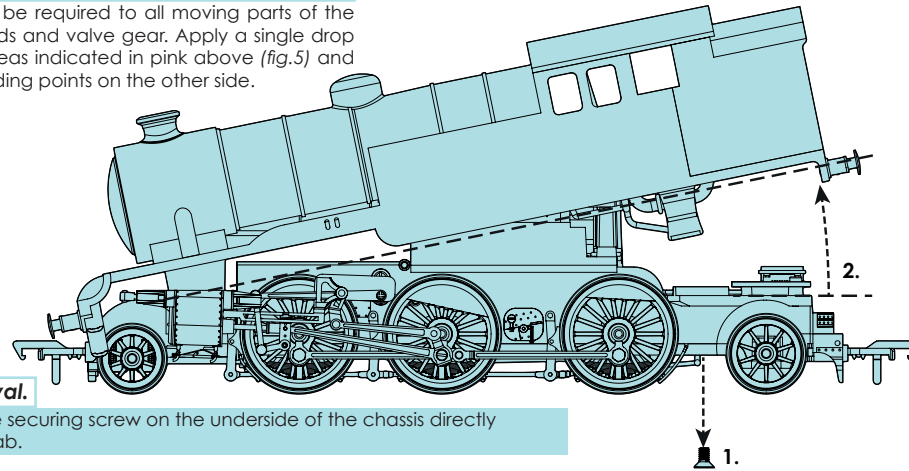

Body Removal.

1. Remove the securing screw on the underside of the chassis directly beneath the Cab.
2. Lift the body off from the cab end of the locomotive. The front is secured by a locating lip on the chassis that corresponds with a slot on the body.

Front Motor Bearing Lubrication.

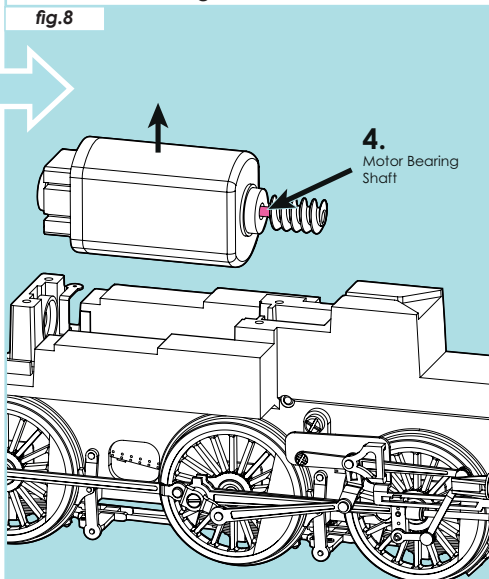

4. Lubricate the front end of the motor bearing shaft.

4. DCC Decoder - Fitting a Next18 DCC Decoder

Digital Command Control (DCC) allows for greater functionality and control over the locomotives on your layout: such as the simultaneous control of speed & direction of multiple locomotives and enables the use of DCC controlled track, points and other DCC Decoder fitted accessories. DCC also allows the addition of DCC Sound which brings a whole new level of realism to your model railway.

1. Remove the DCC blanking plate.
2. Push fit a Next18 DCC decoder into the socket on the PCB board as shown.

fig.9

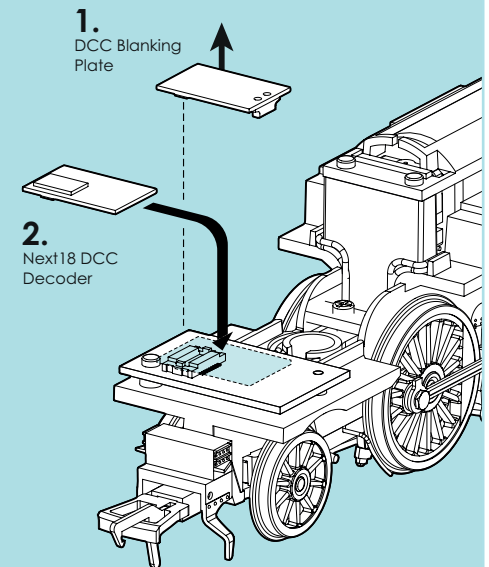

5. DCC Sound - Installing DCC Sound

The following equipment is required for DCC Sound.

- 1 x Next18 DCC Sound Decoder (pre-programmed with the relevant sound file of your choice).
- 1 x 'Sugar Cube' Speaker no bigger than 15 x 11 x 9mm.
- 2 lengths of suitable wire to connect the speaker to the PCB Board.

Please note: It's recommended that the DCC Decoder and Speaker are both from the same manufacturer and the speaker specifications are compatible with the decoder. Please consult your retailer for advice.

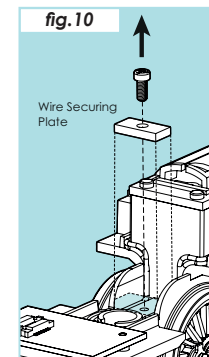

1. Remove the wire securing plate.

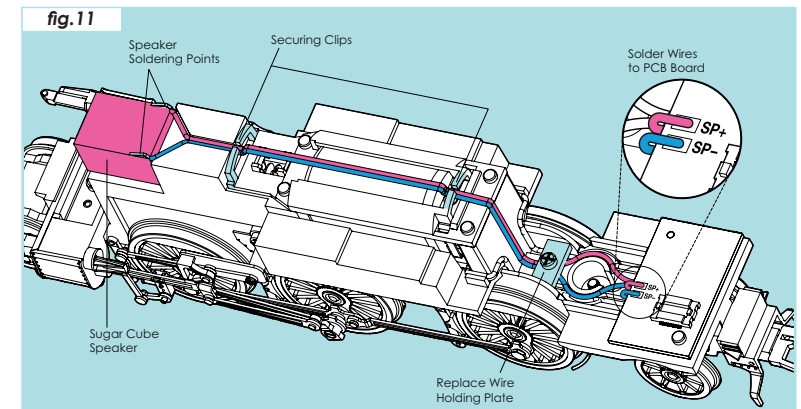

2. Solder the two wires to the soldering pads on the PCB board marked 'SP+' & 'SP-', fit into the grooves and clips provided and replace wire holder. (**fig.11**)

3. Fit your Sugar Cube Speaker (no bigger than 15 x 11 x 9mm) into the space shown and solder to the corresponding '+' & '-' wires that were fitted earlier.